

GENUINE SPARE PARTS.

Owners of Ariel Machines will sometimes find that when they require a replacement or spare part, they are offered an imitation or non-genuine Ariel part, at probably a slightly lower cost. In practically every case, lower cost means lower quality, either in material or workmanship.

Two valves may look absolutely alike. The Ariel valve is of the most suitable quality alloy steel for the work which it has to do. The quality of the imitation valve is unknown, and the valve may fail when in the engine, with serious consequences and a heavy repair bill.

Aluminium alloy pistons may be die-cast or sand-cast. Die-casting gives a close grained compact metal free from flaws and weaknesses, and every piston is the same weight. Sand-casting leaves the metal irregular and porous, and gives castings of varying weight, but is cheaper than die-casting when only a few pistons are being made. All Ariel pistons are die-cast from the very best alloy, and are, therefore, free from flaws and uniform in weight. Do not spoil a smooth-running engine by fitting a piston of doubtful composition and unknown weight.

Such a machine as the Ariel is worthy of the best spares that can be obtained.

Ariel Spares are the Best!

PRICE LIST OF SPARE PARTS FOR THE MODERN **ARIEL** MOTOR CYCLE

Prices given in this List are subject to alteration without notice.

LIST OF SPARE PARTS FOR THE YEAR 1931

1931

250 c.c. | **MODELS**
350 c.c. |

請 購

ARIEL WORKS LTD.
SEELY OAK
BIRMINGHAM

Telephone :
General Seely Oak 1221
Service only Seely Oak 1227.

Telegrams
Ariel, Seely Oak.

Very Important!

Read carefully before ordering Spare Parts
and see Page 63.

THE terms of spare parts are net cash with order, together with a suitable amount to cover postage or carriage. Deposit accounts may be opened.

When goods are ordered and remittance is not enclosed, parts will as far as possible be despatched immediately per C.O.D. post.

Always state your requirements clearly, not forgetting to state frame and engine numbers with the letter preceding each number, also type and year of machine. Do not include your order for spares in a letter relating to other things; give the order on a separate sheet, so that it may be sent to the Service Department without delay.

When in doubt send the old parts as patterns, and do not forget to include your name and address.

When telegraphing a money order do not fail to give your name and address, and concise particulars of your requirements. Should parts be returned for repair be sure they are securely packed, otherwise costly damage may occur. Always pack an engine or a cylinder in a stout box with plenty of padding. All goods consigned to the factory must be carriage paid. Machines returned for overhaul or repair should be stripped of all accessories; we cannot be responsible for lamps, horns, licences and the like.

Name and address of the sender should always be attached to returned machines and parts, and a letter of advice posted separately.

We are pleased to give estimates for overhauls and repairs, but cannot give firm quotations as necessities may be discovered not foreseen when estimating.

Should an estimate not be accepted, payment for dismantling and re-assembling must be made.

INDEX OF PARTS.

	Page
Ariel Spares Stockists	63
Battery (electric lighting)	66
Brake Pedal with rod and fittings	34
Carburettor—Mixing Chamber	42
Pilot Chamber	42 & 44
Twist Grip Control	38
Lever Control	38
Carrier	20
Chain Covers	28
Chains (Driving)	28
Crankcase and Fittings	10
Cylinder and Fittings, S.V.	4
Cylinder and Fittings, O.H.V.	4
Engine Plates	14
Exhaust Pipes	28
Exhaust Valve Lifter	5
Flywheel Assembly	8
Footrests	24
Frame Parts	22
Front Forks, Mudguard and Fittings	18
Gearbox Parts, Bergman Model R.P.	48
Gear Control Parts	24
Gear Cover and Fittings	12
Handlebars and Fittings	38, 39 & 40
Head, O.H.V.	4
Lamp—Head	84 & 80
Tail	55
Lighting Set Fittings	30
Magneto	50
Magnets	58
Magneto Fixing	14
Mudguard (Rear) and Fittings	26
Nuts	34
Oil Pump Parts	14
Oil Tank and Fittings	28
Oil Gauge and Fittings	23
Petrol Tank and Fittings	22
Pillion Footrests	20
Pistons and Fittings	10
Repair Prices	63
Rocker Box and Fittings	6
Saddle and Fittings	32
Shock Absorber. Engine Shaft	8
Silencers and Fittings	28
Speedometer Fittings (see also under gearbox)	24
Sprockets (Engine)	8
Stands, Front and Rear	24
Steering Head and Fittings	20
Steering Damper	20
Tie Bolts	14 & 32
Timing Gear	10
Tool Kit	44
Valves and Fittings	6
Washers	34
Wheel and Hub—Front	26

S.V. & O.H.V. CYLINDERS & FITTINGS.

Order by SPARES No.	Do not use PART No.	DESCRIPTION OF PART.	No. Per Set.	Price, Each. £ s. d.
120-29	A4/289C	S.V. Cylinder, complete with all fittings, but less tappets	1	8 11 0
15-29	A4/284	S.V. Cylinder, fitted with Valve Guides and Tappet Guides	1	4 0 0
280-21	A4/73C	O.H.V. Cylinder Barrel and Tappet Guides, 250 cc.	1	2 8 0
28	-31 A4/73	O.H.V. Cylinder Barrel only, 250 cc.	1	2 0 0
280-29	A4/871C	O.H.V. Cylinder Barrel, with Tappet Guides, 250 cc.	1	2 0 0
28	-29 A4/827	O.H.V. Cylinder Barrel only, 250 cc.	1	1 18 6
280-31	A4/74AC	O.H.V. Cylinder Head complete with Valves, Guides, Inlet Pipe, etc., less Rocker Box, 250 cc.	1	4 7 0
28	-31 A4/74C	O.H.V. Cylinder Head and Valve Guides, 250 cc.	1	3 5 0
280-30	A4/888AC	O.H.V. Cylinder Head, complete with Valves and Inlet Pipe, less Rocker Box 2 Port, 250 cc.	1	4 8 0
28	-30 A4/888A	O.H.V. Cylinder Head and Valve Guides only—2 port, 250 cc.	1	3 3 0
28	-31 A4/823	O.H.V. Cylinder Head and Valve Guides only—1 part, 250 cc.	1	2 18 0
280-21	A4/23C	O.H.V. Cylinder Head, complete with Valves and Inlet Pipe, less Rocker Box—1 port, 250 cc.	1	4 0 0
86-29	A4/289	Valve Cap, Inlet	1	3 0
88-29	A4/290	Valve Cap, Exhaust	1	3 0
89-29	A4/291	Valve Cap, Washer	2	3
87-31	A4/45	Inlet Pipe for Carburettor, 3/8" bore	1	3 0
90-31	A4/46	Lock nut for Inlet Pipe	1	6
105-29	A4/828	Valve Spring Cover, S.V.	1	3 6
107-29	A4/827	Tappet Spring Cover, O.H.V.	1	3 6
109-30	A4/704	Washer for Valve Spring Cover	1	4
111-30	A4/707	Washer for Tappet Spring Cover	1	4
0120	A4/035	Stud for Cover	1	4
83-2	S2/3	Lock nuts for Stud	2	1
118-29	A4/642	Fibre Washer for Cover Stud	1	3
127-31	A4/87	Cylinder Base Washer, paper 250 cc.	1	2
130-29	A4/641	Cylinder Base Washer, paper, 250 cc.	1	2
81-2	S1/3	Nut for Cylinder Base	4	1
135-29	A4/517	Nut for Cylinder Base—Special	1	2
85-2	S2/3	Spring Washer	5	1
142-31	A4/89	Oil Pipe for Inlet Valve, complete, 250 cc.	1	2 8
142-30	A4/783C	Oil Pipe for Inlet Valve, complete, 250 cc.	1	2 8
144-30	A4/705	Oil Pipe Union only	1 or 2	8
147-31	A1/219	Nipple for Pipe, 250 cc. (Int. 6177-81)	2	8
0599	A4/829	Cylinder Head Bolt, N.S. 3 1/2" long	2	8
0601	A4/794	Cylinder Head Bolt, O.S. 3 1/2" long	2	8
126-29	A4/335	Tappet Guide	2	0

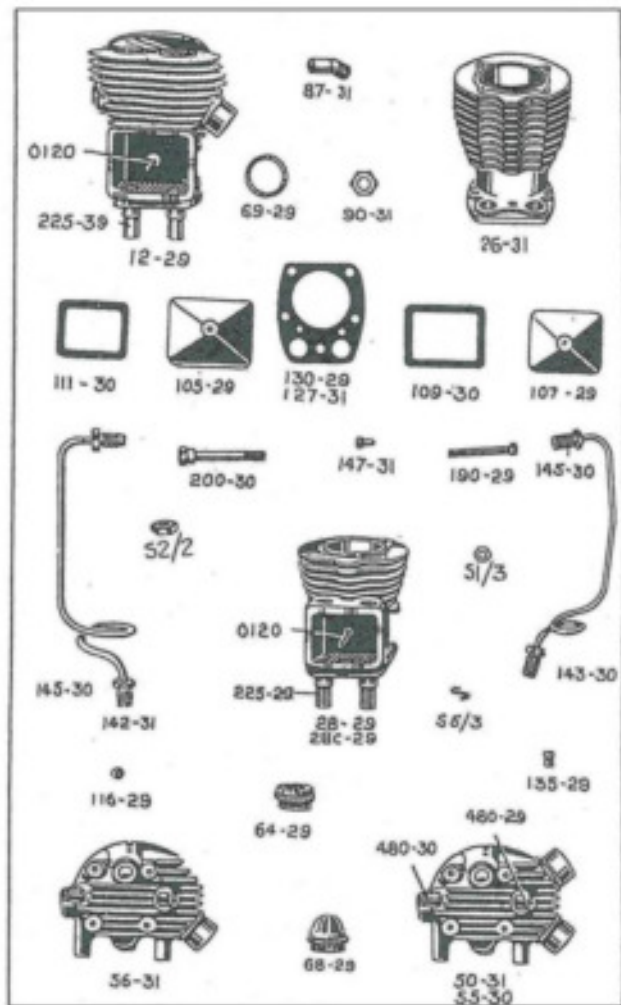

EXHAUST VALVE LIFTER.

Order by SPARES No.	Do not use PART No.	DESCRIPTION OF PART.	No.	Per Set.	Price, Each.	1	2
330-30	A6/700C	Exhaust Valve Lifter, complete, 250 cc. ...	1	...	4	0	
335-30	A6/750	Exhaust Valve Lifter only, 250 cc. ...	1	...	3	0	
335-31	A7/180	Exhaust Valve Lifter only, 350 cc. ...	1	...	3	0	
338-30	A6/749	Exhaust Valve Lifter Lever ...	1	...	1	3	
341-30	A6/761	Exhaust Valve Lifter Bush ...	1	...	0		
52-2	S2/2	Nut for Lifter ...	1	...	1		
55-2	S5/2	Spring Washer ...	1	...	1		
525-2	S25/2	Exhaust Cable Adjuster ...	1	...	1	0	
349-31	A8/90	Exhaust Lifter Washer (on Rocker), 350 cc. ...	1	...	2		
350-29	A6/615	Exhaust Cable Stop Lug ...	1	...	4		
51-2	S1/2	Exhaust Cable Stop Lug Lock Nut ...	1	...	1		

VALVES AND FITTINGS.

Order No. SPARES No.	Do not use PART No.	DESCRIPTION OF PART.	No.	Per Set.	Price, Each.	1	2
405-29	A6/287	Valve, Inlet and Exhaust, S.V. ...	2	...	4	0	
420-29	A6/054	Valve, Inlet, O.H.V. ...	1	...	7	0	
450-29	A6/055	Valve, Exhaust, O.H.V. ...	1	...	7	0	
465-29	A6/296	Valve, Guide, S.V. ...	2	...	2	0	
480-30	A6/056A	Valve Guide, Inlet, O.H.V. ...	1	...	2	0	
480-29	A6/056	Valve Guide, Exhaust, O.H.V. ...	1	...	2	0	
510-26	A6/4	Valve Spring, S.V. ...	2	...	9		
525-29	A6/052	Valve Spring (outer) O.H.V. ...	2	...	1	0	
550-29	A6/053	Valve Spring (inner), O.H.V. ...	2	...	6		
560-29	A6/010	Top Collar for Spring (pressing), S.V. ...	2	...	6		
575-29	A6/051	Top Collar for Spring (pressing), O.H.V. ...	2	...	9		
600-28	A6/9	Bottom Collar for Spring (taper hole), S.V. ...	2	...	9		
610-29	A6/050	Bottom Collar for Spring (taper hole), O.H.V. ...	2	...	9		
620-25	A6/7	Split Cone (2 halves), S.V. ...	2	...	1	0	
635-29	A6/549	Split Cone (2 halves), O.H.V. ...	2	...	1	0	
655-28	A6/003	End Cap for Valve Stem (O.H.V. ...	2	...	9		

O.H.V. ROCKER BOX AND FITTINGS.

Order by SPARES No.	Do not use PART No.	DESCRIPTION OF PART.	No.	Per Set.	Price, Each.	1	2
805-29	A6/039	Rocker Plate, N.S. ...	1	...	3	0	
815-29	A6/038	Rocker Plate, O.S. 250 cc. ...	1	...	3	0	
815-31	A8/93	Rocker Plate, O.S. with Exhaust Lifter Bush, 250 cc. ...	1	...	4	3	
850c-30	A6/037AC	Rocker Box fitted up complete, 250 cc. ...	1	...	12	0	
850c-31		Rocker Box fitted up complete, including Exhaust Lifter, 250 cc. ...	1	...	14	0	
850-30	A6/037A	Rocker Box only ...	1	...	2	0	
873-29	A6/041	Rocker Box Joint Washer, N.S. ...	1	...	6		
878-29	A6/040	Rocker Box Joint Washer, O.S. ...	1	...	6		
885-29	A6/430	Dowel Peg (locating joint washer) ...	5	...	1		
905-29	A6/047	Rocker Pin ...	2	...	2	0	
51-4	S1/4	Rocker Pin Nut ...	2	...	2		
519-4	S19/4	Plain 1" Washer ...	2	...	1		
915-29	A6/023	Rocker Lever with End Pin, Inlet ...	1	...	6	0	
925-29	A6/024	Rocker Lever with End Pin, Exhaust ...	1	...	6	0	
930-29	A6/434	Rocker Lever End Pin ...	2	...	1	0	
940-29	A6/048	Grease Nut for Rocker Pin ...	2	...	1	3	

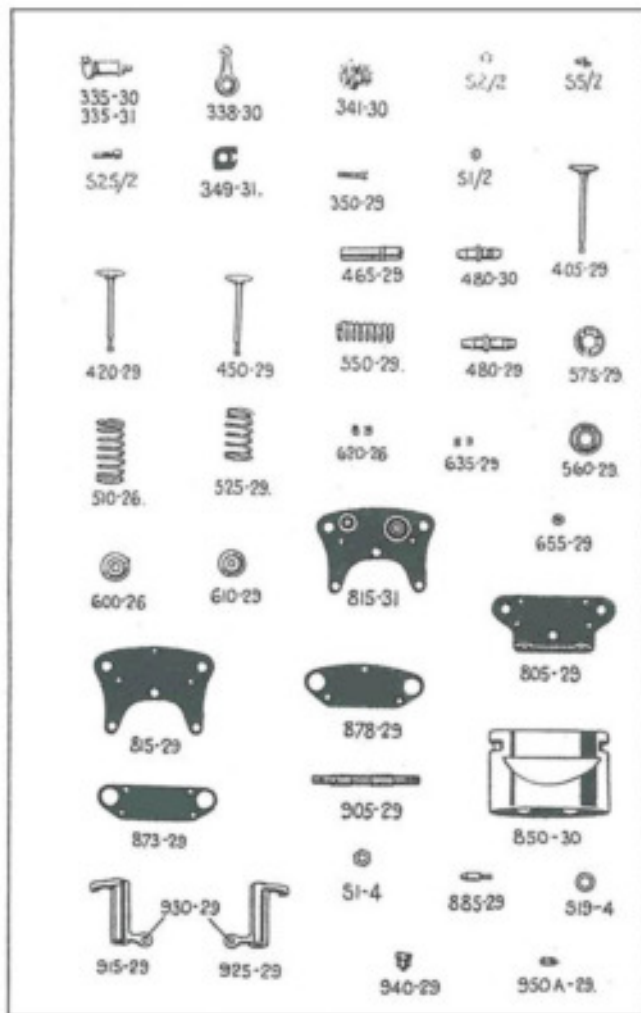

O.H.V. ROCKER AND FITTINGS—Continued.

Order by SPARES No.	Do not use PART No.	DESCRIPTION OF PART.	No.	Per Set.	Per. Exch.	Q. S. d.
950A-29	A4/542	Rocker Distance Washer (thin) ...	2	0
950-30	A4/513	Rocker Distance Collar ...	2	0
0178	A4/544	Rocker Box Stay Bolt, 1/2" dia x 4 1/2" long ...	1	0
81-3	SI/3	Stay Bolt Nut ...	2	1
954-25	A4/545	Rocker Box Stay Bolt Distance Tube ...	1	4
955-30	A4/511	Rocker Return Spring (Inlet) ...	1	0
1055-30	A4/512	Rocker Return Spring (Exhaust) ...	1	0
1010-30	A4/502	Return Spring Anchor Peg ...	2	2
0564	DQ/102	Rocker Plate securing Pin, O.S. 1/8" dia. x 1 1/2" ...	2	0
819-3	SI/31	Plain Washer for 0564 ...	2	1

FLYWHEEL ASSEMBLY.

Order by SPARES No.	Do not use PART No.	DESCRIPTION OF PART.	No.	Per Set.	Per. Exch.	Q. S. d.
1085-31	A4/19	Flywheel (balanced) Gear Side, 200 cc. ...	1	18 0
1086-31	A4/79	Flywheel (balanced) Gear Side, 350 cc. ...	1	18 0
1070-29	A4/305	Flywheel (balanced) Driving Side, 200 cc. ...	1	18 0
1071-31	A4/90	Flywheel (balanced) Driving Side, 350 cc. ...	1	18 0
1076-31	A4/71	Oil Purifier Centre Tube ...	1	0
1077-31	A4/29	Oil Purifier Capped Plug ...	1	0
1078-31	A4/28	Lock Washer for Plug ...	1	0
1085-29	A4/307	Crank Pin & Roller Bearing complete, 200 cc. ...	1	1 5 0
1087-31	A4/81	Crank Pin & Roller Bearing complete, 350 cc. ...	1	1 5 0
1095-29	A4/308	Nut for Driving Spindle and Crankpin, L.H. 3/8" dia. ...	3	0
1115-31	A4/3	Connecting Rod and S.E. Bush, S.V. only, 350 cc. ...	1	17 0
1120-31	A4/4	Connecting Rod and S.E. Bush, O.H.V. only, 250 cc. and 350 cc. ...	1	17 0
1131-31	A4/5	Small End Bush ...	1	2 0
1144-31	A4/82	Driving Spindle, 350 cc. ...	1	6 6
1145-31	A4/7	Driving Spindle, 250 cc. ...	1	6 6
1155-31	A4/25	Gear Side Spindle and Peg A4/518 ...	1	6 3
1175-29	A4/102	Gear Spindle Nut, L.H., 1/2" dia. ...	1	0
1180-31	A4/647	Distance Washer, 12-17 and 17 G., 350 cc. ...	1	3
1185-31	A4/88	No. 9 Woodruff Key, 350 cc. ...	1	3
1188-29	A4/501	No. 81 Woodruff Key for Driving Spindle, 250 cc. ...	1	3
1180-29	A4/315	Peg for Gear Side Spindle and Crankpin ...	1	3

SHOCK ABSORBER AND ENGINE SPROCKETS.

Order by PART No.	Do not use PART No.	DESCRIPTION OF PART.	No.	Per Set.	Per. Exch.	Q. S. d.
1255-29	A4/322	Spring Collar ...	1	6
1255-31	A7/3	Spring ...	1	2 0
1275-30	A4/745	Sliding Member ...	1	4 6
1285-31	A7/1	Driving Member ...	1	0 0
1294-31	A7/2	Locking Sleeve ...	1	2 0
1345-30	A4/771	Engine Sprocket, 16T S.V. or O.H.V., 250 cc. ...	1	10 0
1345-30	A4/744	Engine Sprocket, 17T O.H.V. only, 250 cc. ...	1	10 0
1347-31	A7/233	Engine Sprocket, 18T, 350 cc. ...	1	10 0
1348-31	A7/4	Engine Sprocket, 19T, 350 cc. ...	1	10 0

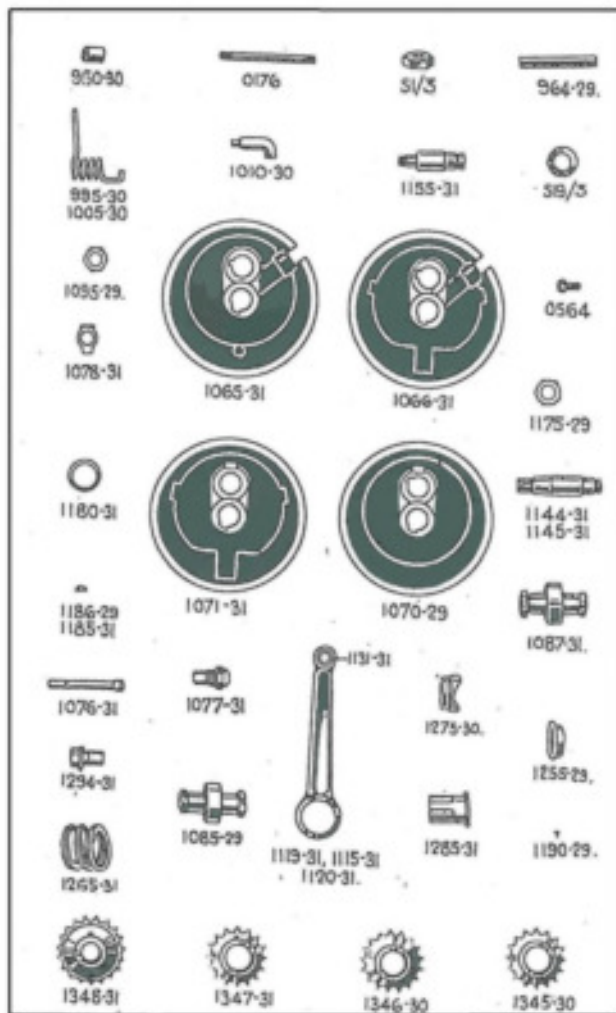

CRANKCASE AND FITTINGS.

Order by PART No.	Do not use PART No.	DESCRIPTION OF PART.	Qty.	Per Set.	Price, Each.	£	s.	d.
1455-31	A8/15/16	Crankcase complete with fixed fittings, bushes and bearings, 250 cc. ...	1	...	4	16	9	
1457-31	A8/77/78	Crankcase, complete with fixed fittings, bushes, and bearings, 350 cc. ...	1	...	4	17	8	
0184	A6/251	Stud for Cylinder, $\frac{5}{8}$ " \times $1\frac{1}{2}$ ", 250 cc. ...	3	...				4
0184S	A6/836	Stud for Cylinder (thickened centre), $\frac{5}{8}$ " \times $1\frac{1}{2}$ " 250 cc. ...	3	...	2			4
0192	A8/83	Stud for Cylinder, $\frac{5}{8}$ " dia. \times $1\frac{1}{2}$ ", 350 cc. ...	3	...				4
1435-29	Z/1	Ball Bearing, R.M.S.7 Drive Side, 250 cc. ...	1	...				10 3
1440-30		Ball Bearing, R.L.S.8 Drive Side, 300 cc. ...	1	...				9 11
1441-30	Z/219	Ball Bearing, R.L.S.7 Gear Side, ...	1	...				8 11
1455-29	A6/328	Camwheel Bush ...	2	...				1 9
1485-31	A8/48	Non-Return Valve Body ...	1	...				1 9
1486-31	A8/49	Non-Return Valve Disc ($\frac{1}{2}$ " dia.) ...	1	...				3
1490-30	A6/623	Oil Breather and Face Block for Tappet Bearing ...	2	...				6
1525-31	A8/12c	Oil Sump Base with Gause ...	1	...				2 6
1525-31	A8/20	Joint Washer for Sump ...	1	...				4
0520	A6/501	Set Screw for securing Oil Sump Base, $\frac{1}{2}$ " \times $\frac{1}{4}$ " Whit ...	4	...				3
1535-31	A8/33	Oil Return Pipe (from sump) ...	1	...				9
1538-29	A6/806	Oil Joint Pipe (return to pump) ...	1	...				3
1545-31	A8/25	Dowel l/2g ...	2	...				3
1547-30	A6/770	Plug Screw for crankcase ...	1	...				6
1548-30	A6/769	Washer for Plug ...	1	...				3

PISTONS AND FITTINGS.

Order by PART No.	Do not use PART No.	DESCRIPTION OF PART.	Qty.	Per Set.	Price, Each.	£	s.	d.
1652-31	A8/1	Piston, S.V. ...	1	...	12	6		
1664-31	A8/70	Piston, 250 cc. ...	1	...	10	6		
1685-31	A8/2	Piston, O.H.V. 250 cc. ...	1	...	14	6		
1675-31		Piston, O.H.V. 250 cc. (high compression) ...	1	...	1	0	0	
1686-31	A8/72	Piston Ring, 250 cc. ...	3	...	1	8		
1680-29	A6/204	Piston Ring, 250 cc. ...	2	...	1	3		
1710-31	A8/6	Gudgeon Pin ...	1	...	3	0		
1717-31	A8/9	Circlip ...	2	...	1			

TIMING GEAR.

Order by PART No.	Do not use PART No.	DESCRIPTION OF PART.	Qty.	Per Set.	Price, Each.	£	s.	d.
1765-29	A6/247	Exhaust Cam and Camwheel ...	1	...	1	0	0	
1766-29	A6/248	Inlet Cam and Camwheel ...	1	...	1	0	0	
1773-29	A6/250	Timing Pinion ...	1	...	3	0		
818-1	S18/1	No. 3 Woodruff Key ...	1	...	3			
1777-31	A8/846	Washer, special (gear side) ...	1	...	4			
1780-29	A6/295	Nut securing Timing Pinion, L.H. $\frac{1}{4}$ " Whit. ...	1	...	2			
1785-29	A6/658	Shim for Cam Spindle (gases 20 to 25, as required)				1
1812-29	A6/261	Tappet, Model L.H. ...	2	...	3	0		
1812-30	A6/758	Tappet, Model L.F. ...	2	...	3	6		
1818-29	A6/44	Tappet Head (Adjusting Screw), S.V. ...	2	...	9			
1818-30	A6/798	Tappet Head (Adjusting Screw) O.H.V. ...	2	...	6			



Order by SPARES No.	Do not use PART No.	DESCRIPTION OF PART.	No. Per Set.	Page, Exam. of 4.
82-3	SR/3	Tappet Head, Locknut, S.V....	2	1
1835-30	A6/750	Tappet Head Locknut, O.H.V.	2	2
1835-28	A6/800	Washer (special) on tappet for exhaust filter, S.V.	1	2
1835-30	A6/820	Washer (special) on tappet for exhaust filter, O.H.V.	1	2
1856-31	A6/88	Tappet Tube with ends, 380 cc.	2	6 6
1886-30	A6/810	Tappet Tube with ends, 250 cc.	2	6 6
1876-31	A6/86	Washer (top) tappet tube cover, 380 cc.	4	1
1876-31	A6/87	Washer (bottom) tappet tube cover, 380 cc.	2	1
1884-31	A6/88	Spring for Tappet Tube Cover, 380 cc.	2	4
1905-31	A6/854	Tappet Tube Cover, O.H.V. 250 cc.	2	2 0
1906A-31	A6/84	Tappet Tube Cover (top), 350 cc.	2	1 0
1906B-31	A6/85	Tappet Tube Cover (bottom), 380 cc.	2	2 8
1913-30	A6/795	Fibre Washer for Cover, 250 cc.	2	3
1921-31	A6/85	Magneto Driving Sprocket (Cam Spindle)	1	8 0
1925-31	A6/83	Magnita Driving Sprocket (Cam Spindle)	1	7 8
1928-31	A6/87	Magneto Sprocket	1	8 0
1928-31	A6/83	Magnita Sprocket	1	4 8
1930-30	A6/743	Nut securing 1921-31	1	2
1930-31	A6/85	Nut securing 1922-31	1	4
1932-28	A6/597	Nut (special) securing Magneto Sprocket Magneto Chain, 7" pitch x 48 pitches	1	6 8
1932-31		Magneto Chain, 8 mm. Duplex x 64 pitches	1	7 2

GEAR COVER AND FITTINGS.

Order by SPARES No.	Do not use PART No.	DESCRIPTION OF PART.	No. Per Set.	Page, Exam. of 4.
2005-31	A6/18	Gear Cover with bushes and oil pipe	1	11 0
2010-29	A6/528	Bush for Camshaft	2	1 0
2020-31	A6/17	Magneto Chain Cover	1	10 8
2028-31	A6/80	Joint Washer (Crankcase—Gear Cover)	1	8
2040-29	A6/947	Paper Washer (.005" thick)	1	1
2048-31	A6/40	Joint Washer (Gear Cover—Chain Cover)	1	1 0
2086-30	A6/775	Oil Feed Pipe	1	1 0
2086-30	A6/780	Screw securing Oil Pipe	1	9
2081-31	A6/85	Cork Washer (Magnita Armature)	1	4
2092-31	A7/125	Cork Washer, Magdyno Armature	1	4
2096-31	A6/80	Oil Retaining Washer, Mag. Armature	1	1 3
2097-31	A6/83	Spring Washer for 2096-31	1	4
2787-31	E10/88	Rivet securing Washer 2097-31	2	1
2104-31	A6/29	Downs Peg for Oil Pipes Adaptor Connection	1	2
2120-30	A6/760	Body for Oil Gauge	1	8 0
2120-30	A6/768	Fibre Washer (small)	1	1
2120-30	A6/767	Fibre Washer (large)	1	1
80-1	SR/1	Ball, 1/8" dia.	1	1
2124-30	A6/764	Spring	1	2
2126-30	A6/765	Punger for Ball Valve	1	2
2126-30	A6/808	Oil Pressure Adjusting Screw	1	2
2127-20	E2/234	Locknut (Int. 2744-28)	1	1
812	A6/20	Cheese Headed Screw (1/2" dia. x 1 1/2")	1	6
814	A6/23	Cheese Headed Screw (1/2" dia. x 1 1/2")	1	4
818	A6/24	Cheese Headed Screw (1/2" dia. x 1")	1	4

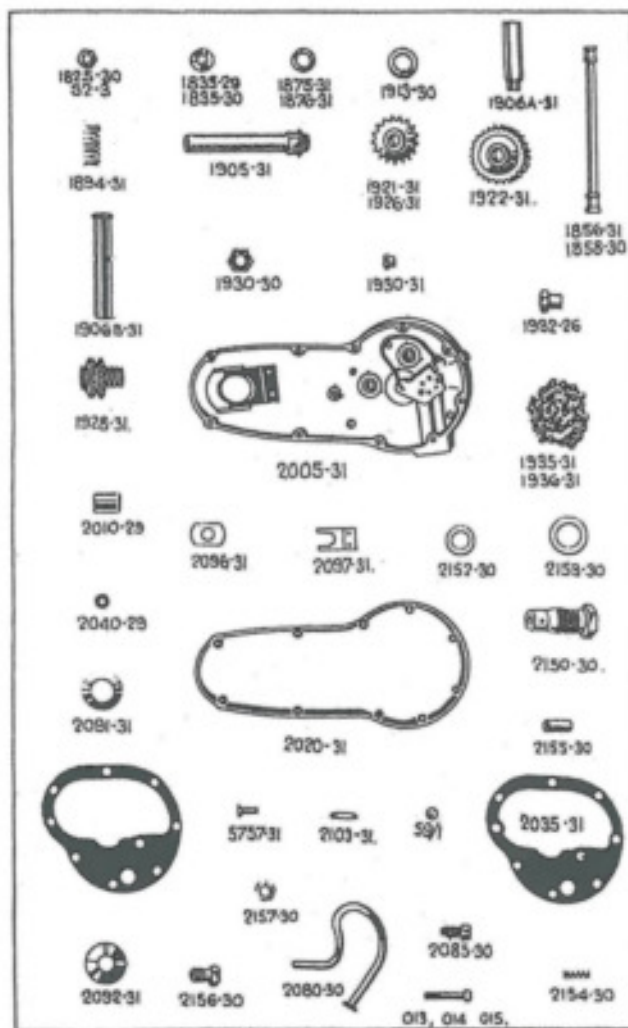

Order by SPARES No.	Do not use PART No.	OIL PUMP DESCRIPTION OF PART.	No.	Per Set.	Price, Each.
2212-29	A6485c	Pump complete with plungers, etc.	1	1	5 0
2212-29	A6485	Oil Pump Body	1	12	0
2214-29	A6481	Paper Joint Washer	1	1	1
2218-29	A6355	Delivery Plunger	1	5	0
2217-29	A6356	Return Plunger	1	0	0
2218-29	A6354	Duralumin Sliding Block	1	1	0
2218-29	A6665	Plug for Plunger Ball Valve	2	0	0
2220-29	A6666	Spring for Plunger Valve	2	1	2
88-1A	S9/1A	Ball for Plunger Valve, 3/8" dia.	2	1	1
04	A6375	Chrome Head Screw securing Pump, 1/2" dia. x 1/2"	4	4	4

ENGINE PLATES, TIE BOLTS & MAGNETO FIXING.

2302-31	E10/1	Front Engine Plate, O.S.	1	4	0
2303-31	E10/5	Front Engine Plate, N.S.	1	4	0
2307-31	E10/5	Rear Engine Plate, O.S. and Magneto Platform fitted with Brake Pedal Spindle Tube	1	8	0
2308-31	E10/8	Rear Engine Plate, N.S.	1	5	0
2317-31	E10/04	Top Cover for Front Engine Plate	1	1	0
2318-31	E10/53	Front Cover for Front Engine Plate	1	1	0
0276	A6/80	Tie Bolt, 1/2" dia. x 3 1/2" long	1	0	0
0277	E8/748	Tie Bolt, 1/2" dia. x 3 3/8" long	2	0	0
0282	A1/52	Tie Bolt, 1/2" dia. x 3 1/2" long	1	0	0
0283	E30/71	Tie Bolt, 1/2" dia. x 3 1/2" long	1	0	0
0278	E8/410	Tie Bolt, 1/2" dia. x 4 1/2" long	1	0	0
0284	A8/47	Tie Bolt, 1/2" dia. x 4 3/8" long	1	0	0
0290	E30/100	Tie Bolt, 1/2" dia. x 4 1/2" (for stand)	1	0	0
0720	E10/70	Bolt—Brake Pedal Stop, 1/2" dia. x 3 1/2" long overall	1	0	0
81-4	S1/4	Nuts for Tie Bolts, 1/2" dia.	14	2	0
88-4	S8/4	Spring Washers, 1/2" dia.	4	1	0
2309-31	E10/87	Distance Tube—engine plates	2	0	0
2321-31	E10/41	Platform for Magneto, Magdyno or Maglita	1	4	0
2322-31	A8/101	Base Plate for Magneto, 200 cc.	1	1	0
2323-31	A8/102	Screw for Base Plate, 200 cc.	5	0	0
2329-31	E10/21	Eccentric for Chain Adjustment	1	0	0
2334-31	E10/80	Link for Eccentric—gearbox connection	1	0	0
2328-31	E10/61	Locknut for Adjuster	1	0	0
2352-31	A7/120	Locating Peg for Magneto, Magdyno or Maglita	2	0	0
2353-31	A7/41	Clamping Screw, R.H. and L.H. Thread	1	0	0
2350-31	A8/07	Strap for Magneto	1	1	0
2370-31	A8/02	Strap for Magdyno (Lucas)	1	1	0
2371-31	A8/03	Strap for Magdyno (Bosch)	1	1	0
2372-31	A8/04	Strap for Maglita	1	1	0
2375-31	A7/42	Swivel Pin, R.H. Thread	1	0	0
2378-31	A7/43	Swivel Pin, L.H. Thread	1	0	0
2377-31	A7/507	Swivel Pin, plain hole (Bosch only)	1	0	0
2379-31	A7/508	Clamping Bolt, Special, 1/2" dia. x 1 1/2", 18 thds (Bosch only)	1	0	0

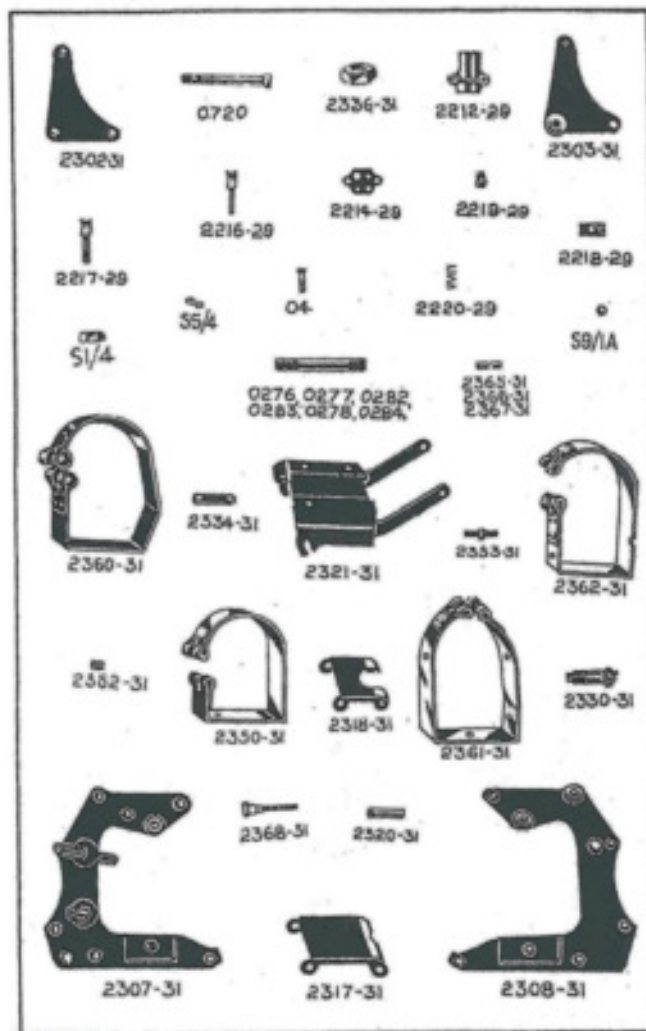

Order by PART No.	Do not use PART No.	FRONT WHEEL AND HUB.	DESCRIPTION OF PART.	No. Per Set.	Price, Each.
4000-39	C14/18a	Wheel complete, less brake parts and tyre,	350 cc.	1	4 10 0
4005-29	C14/18a	Hub and Brake Drum (with spoke ring),	350 cc.	1	1 10 0
4005-31		Wheel complete, less brake parts and tyre,	350 cc.	1	4 10 0
4006-31		Hub and Brake Drum (with spoke ring),	350 cc.	1	1 10 0
4015-29	C13/56	Grease Retaining Cup	2	8
4025-29	C13/78	Spoke Head Guard	1	1 0
088	C13/79	Screw for spoke head guard	3	1
4038-29	C14/44	Wheel Spindle, $\frac{1}{2}$ " x $7\frac{1}{8}$ "	1	3 6
4040-29	C13/94	Taper Roller Bearing complete	2	7 6
4049-29	C13/93	Cone Adjusting Nut	2	4
4050-29	C13/97	Locknut	1	3
4051-29	C13/99	Spindle Washer (next bearing)	1	1
4050-29	C14/51	Wheel Spindle Nut	2	6
4064-29	C14/68	Washer for spindle Nut	2	1
4068-29	C14/63	Distance Piece for hub spindle	2	2
4085-29	C14/50	Brake Plate	1	5 0
4098-29	C14/92	Brake Plate Locknut	1	6
4101-29	C13/104	Brake Shoe	2	3 6
4108-29	C13/92	Brake Shoe Lining ($4\frac{1}{2}$ " x $1\frac{1}{2}$ " x $\frac{1}{8}$ ")	2 per pair	2	0
4108-29	C13/106	Rivet for lining	12 per set	3	
4110-30	C13/107	Brake Shoe Spring	2	6
4118-29	C13/66	Brake Cam, 350 cc.	1	2 0
4118-31	C17/8	Brake Cam, 350 cc.	1	2 0
4118-29	C13/66	Washer for cam spindle	1	1
81-3	S1/3	Nut for cam spindle	1	1
4120-29	C13/87	Brake Cam and Flange Bearing	1	2 0
0521	C13/108	Set Pin for brake cam, $\frac{1}{2}$ " x $\frac{11}{16}$ "	2	4
4132-29	C13/89	Nut for brake cam bearing	2	4
86-3	S8/3	Thackery Washer for brake cam set pin	2	1
4186-29	C14/34	Brake Anchor Bar	1	1 0
0566	E4/75	Brake Anchor Bar Top Bolt	1	3
81-3	S1/3	Top Bolt Nut	1	1
86-3	S8/3	Top Bolt Spring Washer	1	1
4180-29	C14/39	Brake Anchor Pin	1	4
81-3	S1/3	Brake Anchor Pin Nut	1	1
86-3	S8/3	Spring Washer	1	1
4141-29	C14/36	Brake Operating Lever and Swivel Piece	1	1 3
4148-29	C13/83	Brake Cam Spindle Washer (dished)	1	2
4161-29	C14/67	Brake Rod, with cable connection, $\frac{1}{8}$ " butted	$\frac{1}{8}$ " x 17 "	1	1 9
4165-29	C14/16	Rod and Cable Connection only	1	6
4168-27	C14/16	Brake Rod Adjusting Nut	1	4
4504-29	Z/23	Rim WM-1-19 (28" x 3" tyre)	1	9 0
4550-29	C14/82	Spokes with Nipples 10G (62" type)	26 per set	8	6
4551-29	Z/48	Spoke for brake side, $7\frac{1}{2}$ " long	4d. each complete		
4552-29	Z/49	Spoke for spoke ring side, $8\frac{1}{2}$ " long	with nipple.		
801	Z/4	Grease Gun Nipple—plain	1	3

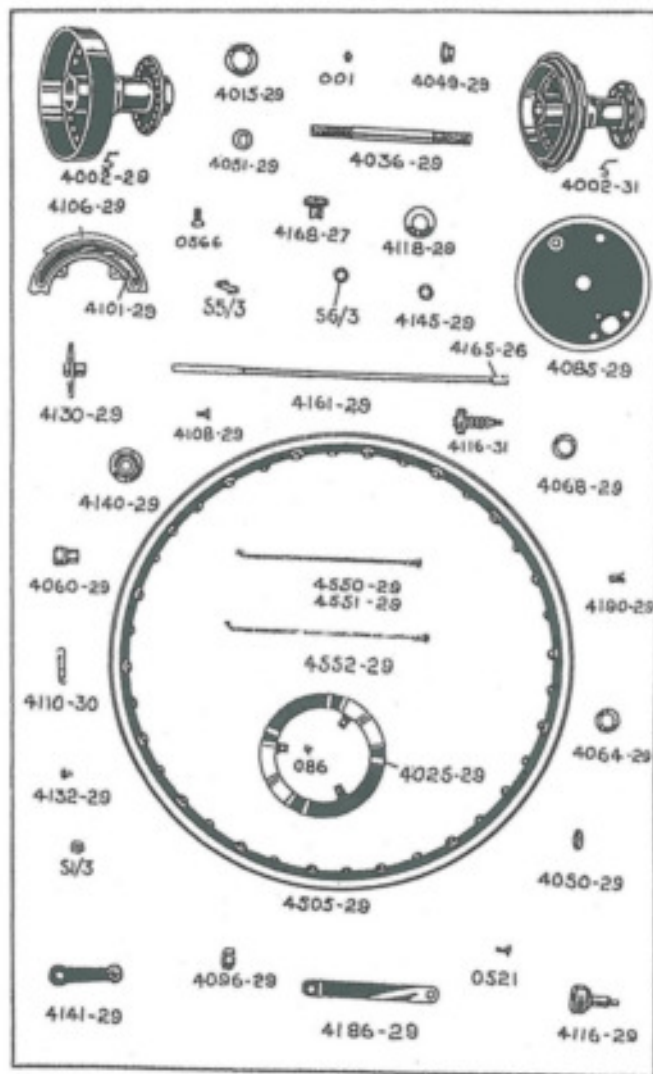

Order by
SPARE No. PART No.

4310-31	
4310-29	C13/71
4313-30	C13/130
0622	C13/94
31-2	S1/3
4319-29	C13/85
4015-29	C13/55
4035-29	C13/78
086	C13/79
4331-31	C17/7
4040-29	C13/94
4049-29	C13/89
4050-31	C17/6
4051-29	C13/99
4353-29	C13/90
819-6	S19/5
4365-31	C17/4
4361-31	C17/3
4191-29	C13/104
4196-29	C13/92
4198-29	C13/100
4110-30	C13/107
4119-29	C13/98
4116-31	C17/8
4118-29	C13/95
81-3	S1/3
4130-29	C13/87
0821	C13/103
4132-29	C13/89
85-3	S5/3
4402-29	C13/48
4445-29	C13/83
4415-29	C13/82
4555-29	C14/92
4556-31	
4557-29	Z/49
001	Z/4
4504-29	Z/32

REAR WHEEL AND HUB.

DESCRIPTION OF PART.		No. Per Set.	Price, Each.	Q. C.
Wheel complete, less brake parts and tyre	...	1	10	0
Rear Hub Brake Drum and Spokes Ring	...	1	10	0
Chain Sprocket, 5" pitch x .305 x .537.	...	1	18	0
Set Pin for chain sprocket	...	6	...	4
Set Pin Nut	...	6	...	1
Lock Washer for chain wheel bolt	...	6	...	1
Grease Retaining Cup	...	2	...	6
Spoke Head Guard	...	1	...	1
Screw for spoke head guard	...	3	...	1
Rear Wheel Spindle	...	1	...	4
Taper Roller Bearing complete	...	2	...	7
Cone Adjusting Nut	...	2	...	6
Locknut	...	1	...	9
Spindle Washer (next bearing)	...	1	...	1
Hub Spindle Nut	...	2	...	4
Washer for Spindle Nut	...	2	...	1
Brake Plate	...	1	...	3
Brake Plate Locknut	...	1	...	6
Brake Shoe	...	2	...	3
Brake Shoe Lining, 4 1/2" x 1 1/2" x 1/8"	2 per pair	2	...	0
Rivet for lining	...	12	per set	3
Brake Shoe Spring	...	2	...	6
Brake Cam, 200 cc.	...	1	...	2
Brake Cam, 300 cc.	...	1	...	2
Washer for cam spindle	...	1	...	1
Nut for cam spindle	...	1	...	1
Brake Cam Flange and Bearing	...	1	...	2
Set Pin for brake cam	...	2	...	4
Nut for brake cam bearing	...	2	...	4
Spring Washer	...	1	...	1
Brake Operating Lever	...	1	...	1
Brake Cam Spindle Washer (dished)	...	1	...	2
Spring for brake lever	...	1	...	6
Spokes with nipples 10G (02 type)	30 per set	30	per set	8
Spoke for brake side 10G (butted 8G)	4d. each complete with nipple.	4	each complete with nipple.	3
Spoke for spoke ring side, 8 1/2" long	...	1	...	3
Grease Gun Nipple—plain	...	1	...	3
Hin WM1-19 (2 1/2" x 3" tyre)	...	2	...	9

FRONT FORKS.

Order by
SPARE No. PART No.

4603-29	D9/107
4606-29	D9/143
4614-29	D9/131
0890	D9/130
4627-29	D9/123
4642-29	D9/122

DESCRIPTION OF PART.		No. Per Set.	Price, Each.	Q. C.
Forks, complete with Steering Column, Head Clip, Ball Races, Spindles, Links, etc. (less mudguard)	...	1	...	6
Fork Assembly—built up only	...	1	...	3
Fork Spring	...	1	...	4
Spring Anchorage	...	1	...	3
Bolt for spring anchorage (1/2" dia. x 1")	...	1	...	6
Fork Link	...	4	...	2
Link Bolt (short—8 1/2")	...	2	...	1

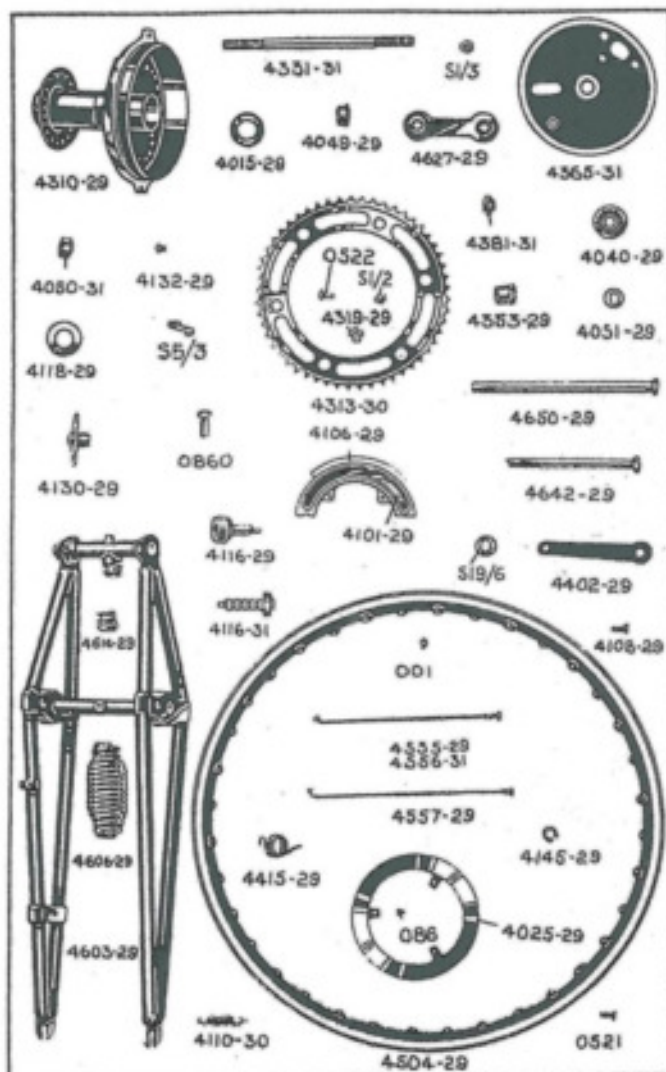

Order No. SPARE No.	Do not use PART No.	FRONT FORKS—Continued. DESCRIPTION OF PART.	No. Per Set	Price, Each.
4650-29	D9/121	Link Bolt (long— $5\frac{1}{2}$ ")	2	1 8
817-3	S17/3	Split Pin for link bolt	4	1
4685-29	D9/134	Friction Disc	8	0
4701-31	D11/8	Mudguard and Bridge (valanced), 350 cc.	1	13 8
4701A-31	D11/8	Mudguard and Bridge (valanced), 350 cc.	1	13 6
4714-29	D9/140	Mudguard Stay, 350 cc.	2	2 9
4714-31	D9/309	Mudguard Stay, 350 cc.	2	2 9
0512	E8/1100	Mudguard Bridge Bolt, $1\frac{1}{2}$ " x $1\frac{1}{8}$ "	2	6
81-2	S1/2	Mudguard Bridge Bolt Nut	2	1
85-2	S3/2	Spring Washer	2	1
4718-29	E8/105	Washer (special) for E8/1100	2	1
0510	E1/90	Bolt for guard stay, $1\frac{1}{2}$ " dia. x $1\frac{1}{2}$ "	4	4
819-2	S10/2	Plain Washers	4	1
81-2	S1/2	Nut	4	1
85-2	S3/2	Spring Washer	4	1
4744-31	D11/4	Number Plate	1	4 8
4748-30	Z/182	Number Plate Connection	2	8
81-2	S1/2	Number Plate Connection Nut	2	1
85-2	S3/2	Spring Washer	2	1
085	D11/7	Screw for number plate	2	1
81-1	S1/1	Screw Nut	2	1
83-5	S2/5	Nut for link bolt, $\frac{3}{8}$ " Whit.	4	0
4750-27	D9/29	Spring Box (Brake Connection)	1	0
4752-27	D9/31	Spring for connection	1	3
4755-29	D9/146	Nipple for front fork boltress	1	4
001	Z/4	Grease Gun Nipple, plain	2	3
003	E8/874	Grease Gun Nipple, elbow	3	0
003a	E8/870	Grease Gun Nipple Nut	2	1

STEERING HEAD AND FITTINGS.

4805-29	D9/123	Steering Column and Crown	1	14 8
4815-29	D9/137	Cone for steering head bearing	2	2 3
4820-29	D9/130	Cup for steering head bearing	2	2 3
89-2	S0/2	Balls (18 each bearing) $1\frac{1}{2}$ " dia.	per set	1 3
4827-30	D9/180	Ball Head Clip	1	11 8
0502	E8/142	Bolt for ball head clip, $\frac{3}{8}$ " x $1\frac{1}{4}$ "	1	0
81-3	S1/3	Nut for ball head clip bolt	1	1
4830-29	D9/128	Spherical Washer	2	3
4833-27	D9/80	Cap (securing handlebars) for head clip	2	1 0
0503	D9/81	Bolt for Cap D9/80 ($\frac{1}{2}$ " x $1\frac{1}{4}$ ")	2	8
4838-29	D9/134	Lock Nut for head	1	0
4839-29	D9/135	Dome Nut for head	1	1 0
4839-29	D9/142	Felt Oil Retainer	1	4
4840-29	D9/141	Dust Cover	1	4
001	Z/4	Grease Gun Nipple—plain	2	3

STEERING DAMPER.

4900-29	D9/C6	Steering Damper complete	1	7 8
4801-20	D9/100	Wing Nut	1	2 0
0185	D9/171	Tie Bolt	1	1 0
4807-29	D9/170	Locating Plate and Sleeve	1	1 8
4909-29	D9/173	Spring	1	9

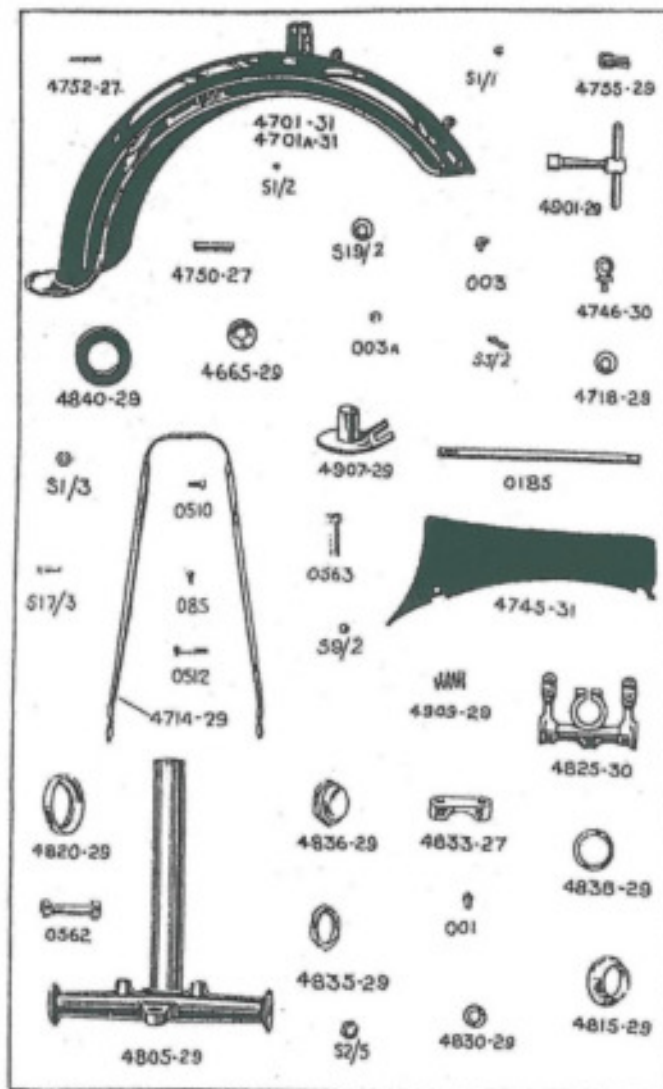

Order by SPARES No.	Do not use PART No.	DESCRIPTION OF PART.	No. Per Set.	Price, £ s. d.
4910-29	D9/172	Spring Container	1	6
4915-29	D9/187	Friction Disc	1	1 0
4915-29	D9/186	Anchor Plate	1	2 0
4923-29	D9/174	Clip for anchor plate	1	9
5070-29	EA/677	Bolt for clip	1	3
4925-29	EA/678	Swivel Piece for bolt	1	1
SI-2	SI/2	Nut for bolt	1	1
4927-29	D9/134	Locknut for steering head (Replaces 4926-29 —dome nut)	1	9

FRAME.

4951-31		Frame	1	8 15 0
---------	--	-------	---	--------

PETROL TANK AND FITTINGS.

Order by SPARES No.	Do not use PART No.	DESCRIPTION OF PART.	No. Per Set.	Price, £ s. d.
5001e-31	EA/986c	Petrol Tank, complete with all fittings, less oil gauge and spondometer	1	8 1 6
5001-31	EA/986	Petrol Tank, less fittings	1	4 2 0
5012e-30	E./986c	Petrol Filler Cap complete	1	3 6
5012-30	EA/986	Petrol Filler Cap only, with anti-splash and washer	1	1 8
5020-30	EA/986b	Filler Cap Screw	1	1 0
5023-30	EA/991	Leath. Washer, 1" O.D.	1	2
5023-29	EA/932	Leath. Washer, 1" O.D.	1	2
5025-29	EA/929	Washer, filler cap	1	4
5027-30	EA/986	Locking Washer	1	9
5028-30	EA/992	Lock Nut	2	1
5030-30	EA/1076	Petrol Filler Gauge	1	1 6
5032-30	EA/1077	Spring securing petrol filler gauge	1	4
5035-30	EA/1003	Cover for Speedometer hole	1	1 0
5036-29	EA/763	Clamp Bar for cover	1	3
5037-29	EA/782	Spoke for speedometer hole cover	1	2
5038-30	EA/785a	Locknut (spec. for 'R/2)	1	1
5061-30	EA/1182	Petrol Tap and Strainer	2	2 9
2209-26	A3/58	Washer for petrol tap	2	3
5072-31		Petrol Pipe complete, S.V.	1	3 9
5073-31		Petrol Pipe complete, O.H.	1	3 9
821-2	SI/2	Union Nut for petrol pipe	2	2
821-4	SI/4	Nipple for petrol pipe	2	2
5082-27	Z/8	Knee Grips	pair	4 6
5085-27	EA/913	Plate for knee grips	2	6
0586	EA/75	Set Bolt securing front of tank	2	3
81-3	SI/3	Set Bolt Nut	2	1
85-3	SI/3	Set Bolt Spring Washer	2	1
0567	EA/778	Bolt securing rear of tank (1/2" x 1/2" x 2 1/2")	1	6
82-3	SI/3	Securing Bolt Nut	1	1
86-3	SI/3	Securing Bolt Spring and Washer	1	1

OIL PRESSURE GAUGE.

5180-30	Z/113	Oil Gauge complete	1	16 0
5184-30	EA/1081	Spoke	2	4
5186-30	EA/785	Spoke Nut	2	1

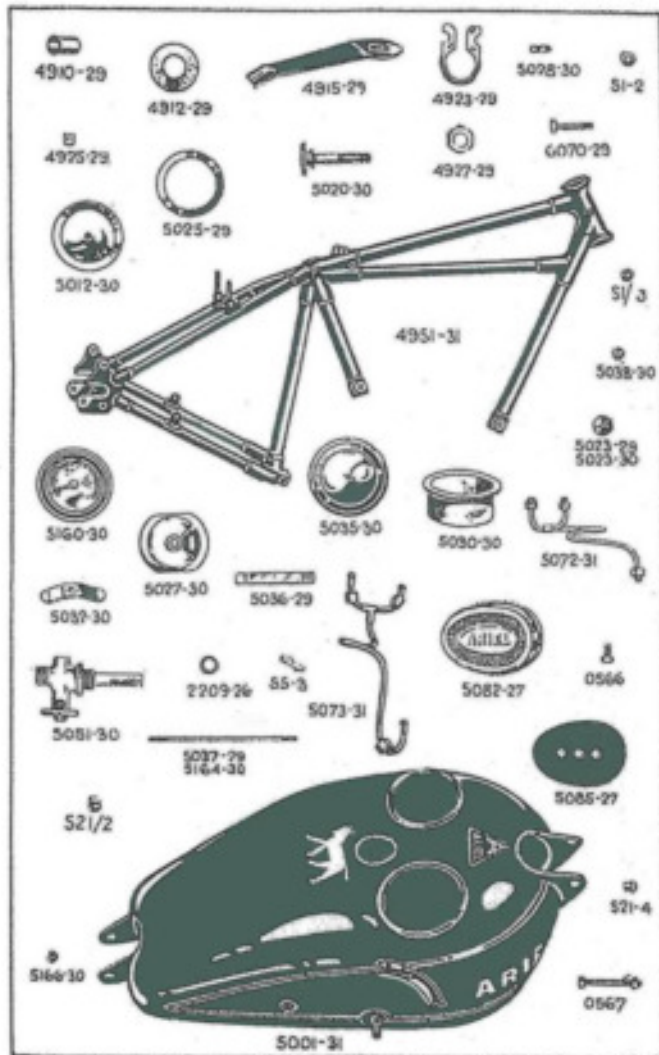

OIL PRESSURE GAUGE—Continued.

Order by SPARES No.	Do not use PART No.	DESCRIPTION OF PART.	Qty. Per Set.	Price, Each. £ s. d.
5171-31	E10/98	Oil Pipe—gear cover end—complete with unions	1	3 0
5175-30	EA/1087	Oil Pipe—gauge end—complete with union and nut	1	2 0
5180-30	EA/982	Clip, aluminium flat strip	1	2

SPEEDOMETER FITTINGS.

5200-29	Z/72	Speedometer Head only—80 m.p.h.	1	10 0
5201-29		Speedometer Head only—140 m.p.h.	1	10 0
5210-99	Z/7	Tie Bar and Nut securing speedometer	2	0
5213-93	EA/747	Clamp Bar securing speedometer	1	0
5215-99	AS/813	Clip securing speedometer cable to crankcase	1	0
5227-29	Z/6	Driving Cable and Casing, 30"	1	13 0
5232-29	Z/73	Driving Cable, inner flex only	1	0 0
5237-29	Z/74	Driving Cable, outer flex only	1	0 0

GEAR CONTROL PARTS.

Order by SPARES No.	Do not use PART No.	DESCRIPTION OF PART.	Qty. Per Set.	Price, Each. £ s. d.
5292-30	EA/1030	Gear Control quadrant	1	2 0
880	EA/1026	Screw for gear quadrant	3	1
85-1	S5/1	Spring Washer	3	1
82-1	S5/1	Locknut	3	1
5295-30	EA/982	Gear Lever and Knob	1	3 6
5290-30	EA/1013	Gear Lever Knob	1	6
5300-30	EA/1010	Flange for pivot	1	6
5301-30	EA/1011	Spring	1	2
88-4	S2/4	Nut for pivot	1	2
5302-30	EA/1012	Spring Cover	1	3
5303-30	EA/1024	Washer for gear lever	1	1
5307-30	EA/984	Gear Control Rod, 1/4" x 10 1/2"	1	2 6
5310-30	EA/1079	Fork End (top)	1	1 0
5315-28	EA/12	Pin for double yoke connection and lower fork end	2	3
5318-30	EA/1061	Double Yoke Connection	1	1 0
5320-28	Z/87 or EA/740	Fork End (lower)	1	0
85-4	S5/4	Spring Washer	1	1

FOOTRESTS, BRAKE PEDAL AND STANDS.

Order by SPARES No.	Do not use PART No.	DESCRIPTION OF PART.	Qty. Per Set.	Price, Each. £ s. d.
5385-31	E10/14	Footrest Distance Tube	1	3
5388-31	E10/12	Footrests, adjustable, O.S.	1	4 6
5387-31	E10/13	Footrests, adjustable, N.S.	1	4 6
8861	E10/15	Footrest Bolt	1	1 6
5392-29	EA/806	Rubber Pad	2	1 0
5401-31	E10/23	Brake Pedal	1	6 6
5403-31	E10/27	Brake Lever and Swivel Pin	1	3 0
5413-31	E10/24	Brake Pedal Spindle	1	3 6
5428-31	E10/46	Brake (rear) Operating Rod, 1/2" dia. x 34 1/2"	1	1 3
819-3	S10/3	Swivel Pin Washer	1	1
5430-29	EA/865	Brake Rod Jaw	1	0
5433-29	EA/869	Joint Pin for 5430-29...	1	2

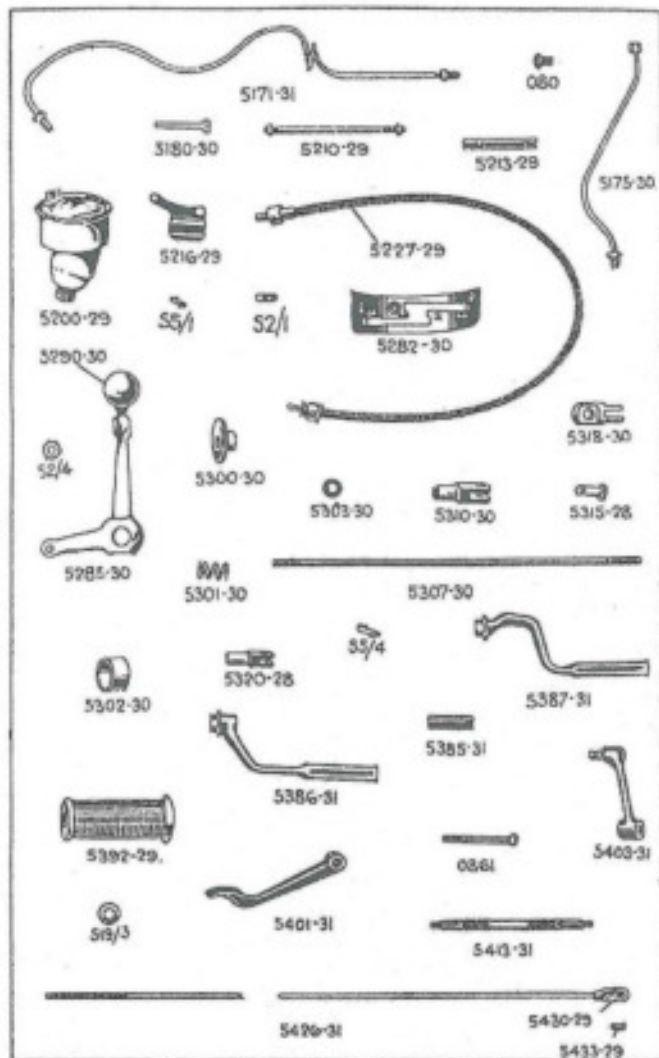

FOOTRESTS, BRAKE PEDAL AND STANDS—Continued.

Order by PARTS No.	See also PART No.	DESCRIPTION OF PART.	No.	Per Sec.	Price, Each.
5435-26	C13/30	Adjusting Nut	1	...	4
5502-30	E8/941	Rear Stand	1	...	15 0
5507-30	E8/933	Rear Stand Bolt	2	...	6
86-8	S6/0	Rear Stand Bolt, Thackery Washer	2	...	3
5510-30	E8/908	Rear Stand Spring	1	...	2 0
5480c-31		Front Stand and Spring Clip	1	...	4 0
5452-31		Spring Clip only	1	...	6

PILLION FOOTRESTS.

5540-29		1 pair Pillion Footrests complete
5542-28	E8/420	Bar for Pad	2	...	3 0
5382-28	E8/605	Rubber Pad	2	...	1 8
5544-28	E8/766	Forked Anchor Pin	2	...	6 0
81-4	S1/4	Forked Anchor Pin Nut	2	...	3
818-4	S18/4	Washer	1	...	1 1
07	E8/766	Screw, securing Bar 5542-28 to anchor pin	2	...	2
82-4	S2/4	Nut	2	...	2
5547-28	E8/423	Thackery Washer	2	...	2

REAR MUDGUARD AND CARRIER.

5589-31	E10/74	Rear Mudguard (detachable), carrier machine	1	...	15 6
5581-31	E10/76	Rear Mudguard (detach), non-carrier machine	1	...	15 6
5583-31	E10/74a	Detachable port only, rear guard	1	...	4 0
5595-31	E10/60	Mudguard Stay, centre	1	...	2 0
5598-30	E8/845	Mudguard Stay, rear	1	...	1 9
5597-30	E8/1102	Mudguard Stay, rear, with lifting handle	1	...	6 6
5602-29	E8/701	Strengthening Plate (mudguard-non-detachable carrier fixing)	1	...	3
5631-30	E8/848a	Carrier loss stay tubes (non-detachable)	1	...	18 0
5631-31	E8/848b	Carrier loss stay tubes (detachable)	1	...	18 0
5638-29	E8/689	Carrier Stay Tube	2	...	1 6
5640-29	E8/780	Carrier Stay Tube Packing Piece	2	...	2
0590	E8/848	Bolt (1/2" dia. x 1 1/4") non-detachable carrier forward fixing	2	...	6
5648-29	E8/691	Rear Number Plate—Export only	1	...	3 6
5648-29	E8/1100	Rear Number Plate—Home only	1	...	2 0
5651-31	E8/1161	Distance Piece for plate—5648-29	1	...	1
5654-31	E10/105A	Special Stud, 1 1/2" overall, N.S. non-detachable carrier bottom fixing	1	...	6
5655-31	E10/102A	Special Stud, 1 1/2" overall, O.S. non-detachable carrier bottom fixing	1	...	6
0195	E10/81	Stud (1/2" dia. x 2") detachable carrier, forward fixing	2	...	3
5658-31	E10/82	Special Stud, 1 1/2" overall, detachable carrier, bottom fixing, O.S.	1	...	6
5657-31	E10/104	Distance Piece for fork end, 1/2" thick	2	...	2
5660-31	E10/105	Special Stud, 1 1/2" overall, detachable carrier, bottom fixing, N.S.	1	...	6
5665-31	E10/83	Head Nut for detachable carrier	4	...	9
828-8	S8/6	Clip securing guard to vent stay bridge	1	...	4
827-3	S27/3	Plate for S8-8	1	...	2
0610	E1/80	Bolt (1/2" dia. x 1")	1	...	4

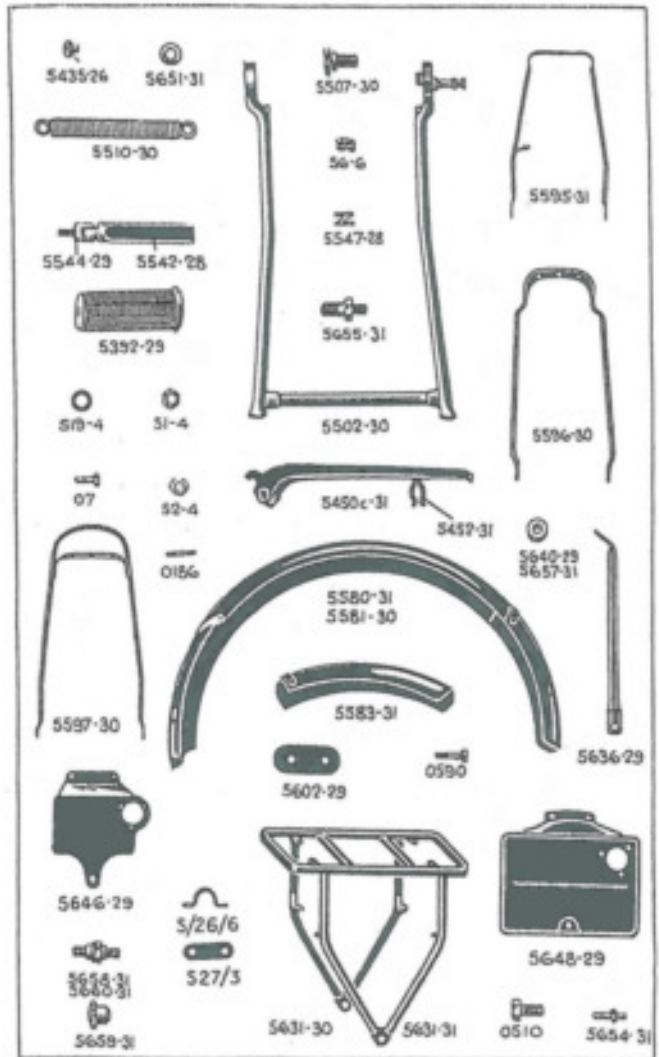

Order by SPARES No.	Do not use PART No.	DESCRIPTION OF PART.	Part. Desc. No. Per Set.	Q. S. D.
0513	E8/294	Bolt (1" dia. x 3/8")	1	3
81-2	51/2	Nut for 1" dia. bolt	1	1
85-2	53/2	Spring Washer for 1" dia. bolt	1	1
0588	E4/73	Bolt (3/8" dia. x 1/2")	1	4
81-3	51/3	Nut for 3/8" dia. bolt	1	1
85-3	53/3	Spring Washer for 3/8" dia. bolt	1	1

CHAIN AND CHAIN COVERS.

Order by SPARES No.	Do not use PART No.	DESCRIPTION OF PART.	Part. Desc. No. Per Set.	Q. S. D.
5712-31	E10/4	Front Chain Cover—outer half	1	2 0
5713-31	E10/3	Front Chain Cover—back half	1	2 0
012	E9/74	Screw for Cover (1/2" dia. x 1 1/2") 20 T.P.I.	5	4
014	A8/33	Screw for Cover (1/2" dia. x 1 1/2") 20 T.P.I.	5	4
016	K10/99	Screw for Cover (1/2" dia. x 2 1/8" 20 T.P.I.	1	4
5725-31	E10/43	Rear Chain Guard—top run	1	7 0
5726-31	E10/39	Rear Chain Guard—bottom run	1	3 0
0523	A7/112	Bolt, Front fixing rear guard	2	3
0513	E8/294	Bolt, Rear fixing—top run	1	3
0597	E10/73	Bolt, Rear fixing—bottom run	1	6
5732-31	E10/50	Bush—inner chain cover	1	3
5741-30	C13/76	Rear Chain Adjusting Screw (fork end) and locknut	2	9
5744-26	58/234	Locknut for 5741-30	1	1
5750-31	E9/94	Inspection Plug and Oil Filler	1	2 0
5753-31	E10/19	Oil Retaining Washer (gearbox mainshaft)	1	3
5755-31	E10/86	Spring Washer for 5753-31	1	4
5757-31	E10/88	Rivet for 5755-31	2	1
5761-31	E10/82	Washer between two halves of chaincase	1	0
5766-31	A8/99	Washer between back chaincase and crankcase	1	2
825-4	822/4	Chaincase "Oil Level" Plug	1	6
2101-30		Washer for Plug	1	3
5770-31	E8/94	Adjusting Screw for Rear Chain Lubrication	1	4
5772-31	E9/95	Spring for 5770-31	1	1
5785-31		Front Chain, 1" x .305", 90 pitches	1	7 0
5786-30	X 223	Front Chain, 1" x .305" 81 pitches	1	7 0
5791-31		Rear Chain, 1" x .305", 110 pitches	1	13 9
5792-31		Rear Chain, 1" x .305", 111 pitches	1	13 9

OIL TANK AND FITTINGS.

Order by SPARES No.	Do not use PART No.	DESCRIPTION OF PART.	Part. Desc. No. Per Set.	Q. S. D.
5851-31	E10/14	Oil Tank	1	2 0
5854-29	E9/500	Filler Cap and Grommet	1	0
5855-29	J9/514	Filler Cap Washer	1	4
0711	E8/425	Bolt securing Tank (top)	1	4
81-3	53/3	Securing Bolt Spring Washer	2	1
5882-31	E9/22	Oil Plug and Grommet	1	0
5884-31		Delivery and Return Oil Pipes with Adaptor Piece	1	3 0
5886-31	A8/41	Washer for Adaptor Connection—Cork	1	2
0598	A8/81	Set Bolt securing Oil Pipe Adaptor to cover	1	6
5886-29	E8/734	Fibre Washer for 5885-31	2	3



OIL TANK AND FITTINGS--Continued.

Order by PART No.	Do not use PART No.	DESCRIPTION OF PART.	Price, U.S.
PARIS No.			No. Per Set. 1 2 3
829-29	EA/779	Rubber Connecting Piece	2 ... 2
81-2	SI/3	Nut for top tank connection	1 ... 1
85-2	SA/3	Spring Washer	1 ... 1
887-31		Clip for connecting piece	1 ... 1
899-30	108/139	Drain Plug	1 ... 1
899-30	AA/668	Drain Plug Washer	1 ... 2

EXHAUST PIPES AND SILENCERS.

Order by PART No.	Do not use PART No.	DESCRIPTION OF PART.	Price, U.S.
PARIS No.			No. Per Set. 1 2 3
8010-31	E10/49	Exhaust Pipe with Baffle, S.V.	1 ... 12 0
8011-31	E10/48	Exhaust Pipe with Baffle (O.H.V. Offside)	1 ... 17 0
8012-31	E10/47	Exhaust Pipe with Baffle (O.H.V. Nearside)	1 ... 17 0
8021-30	EA/1045	Baffle Tube only, S.V.	1 ... 2 0
8022-30	EA/1044	Baffle Tube, O.H.V.	4 ... 2 0
8037-31	E10/94	Silencer, O.S., O.H.V. and S.V.	1 ... 18 0
8038-31	E10/86	Silencer, N.S. O.H.V.	1 ... 18 0
8052-30	EA/1043	Fish Tail, S.V. (baffle 20 holes 1/2" dia.)	1 ... 4 0
8053-30	EA/1043a	Fish Tail, O.H.V. (baffle 20 holes, 1/2" dia.)	2 ... 4 0
8062-29	EA/976	Clip complete securing fish tail	1 0
8063-29	EA/929	Clip complete for exhaust pipe (head joint) S.V.	1 0
8066-29	EA/928	Clip complete for silencer-exhaust pipe joint O.H.V.	1 0
8070-29	EA/977	Pin only for above clips	2 ... 2
8072-29	EA/978	Swivel Piece for 8070-29	9 ... 1
81-2	SI/2	Nut for 8070-29, 1" x 28 t.h.d.	9 ... 1
8077-31	EA/1149	Clip securing exhaust pipe to frame (S.V. only)	1 0
8078-31	EA/1194	Clip securing exhaust pipe to frame (O.H.V. offside)	1 ... 1 0
8079-31	E10/80	Clip securing exhaust pipe to frame (O.H.V. nearside)	1 ... 1 0
8812	EA/294	Bolt for clips 8077-31, 8078-31, 8079-31	3 ... 3
81-2	SI/2	Nut	3 ... 1
85-2	SA/3	Spring Washer	3 ... 1
8881-29	EA/946	Distance Piece for bolt 9716, 1 1/2" inter. dia. x 3/8"	1 ... 3
8882-31	E10/79	Distance Tube for 8286, 1" O.D. x 1 1/8"	1 ... 2
8286	K10/78	Stud—fork end, N.S. silencer fixing, 1" dia. x 2"	1 ... 4
8286	K10/78	Stud—fork end, N.S. silencer fixing, 1" dia. x 2"	1 ... 4
8716	EA/947	Bolt—fork end, O.S. silencer fixing, 1" dia. x 1"	1 ... 4

LIGHTING SET PARTS.

Order by PART No.	Do not use PART No.	DESCRIPTION OF PART.	Price, U.S.
PARIS No.			No. Per Set. 1 2 3
6101-30	EA/1098	Arm for Head Lamp (long), elect. or gas	2 ... 9
6102-30	EA/1099	Arm for Head Lamp (short), elect. or gas	2 ... 6
6103-30	EA/1098a	Arm for Head Lamp (long), Sweden only	2 ... 9
6104-30	EA/1099a	Arm for Head Lamp (short), Sweden only	2 ... 6
8510	E1/80	Bolt for head lamp arm	2 ... 4
81-2	SI/2	Head Lamp Bolt Nut	2 ... 1
85-2	SA/2	Spring Washer	2 ... 1
6110-31		Strap securing Accumulator	1 ... 6

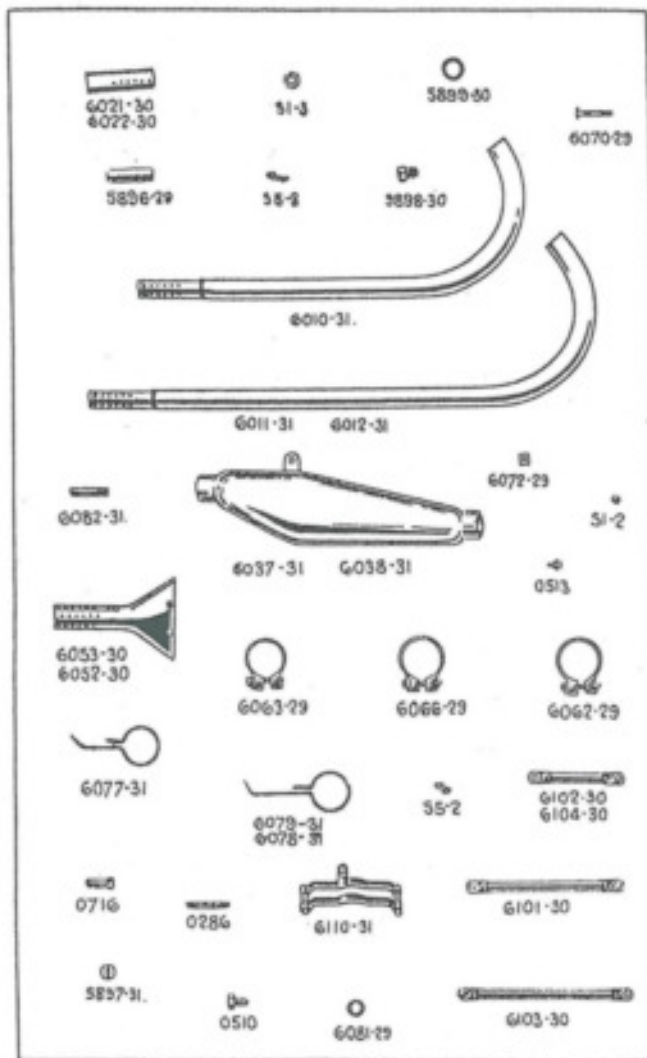

LIGHTING SET PARTS—Continued.

Order by SPARES No.	Do not use PART No.	DESCRIPTION OF PART.	No. Per Set.	Parts, Each. L. H. S.
0100		Tie Bolt for holding Accumulator ...	2	6
6114-29	EA/750	Nut for top of tie bolt ...	2	3
6130-29	EA/787	Acetylene Generator Bracket ...	1	2 0
6131-29	EA/788	Stay for 6130-29 ...	1	6
686	C13/70	Screw for securing generator stay ...	1	1
6151-31	E10/42	Battery Platform ...	1	4 6

SADDLE.

Order by SPARES No.	Do not use PART No.	DESCRIPTION OF PART.	No. Per Set.	Parts, Each. L. H. S.
6893	EA/617	Bolt, front of saddle, $\frac{1}{2}$ " x 2 $\frac{1}{2}$ " ...	1	6
62-3	SE/3	Bolt Locknuts ...	2	1
6216-29	EA/533	Eye Bolt for saddle spring ...	3	9
61-4	SE/4	Eye Bolt Nut ...	4	2
6002-29	7/181	Saddle ...	1	10 0

GREASE NIPPLES, SCREWS, STUDS, BOLTS, TIE BOLTS, Etc.

Order by SPARES No.	Do not use PART No.	DESCRIPTION OF PART.	No. Per Set.	Parts, Each. L. H. S.
Tecalemit Greasers.				
001	Z/4	Straight type, push on, $\frac{1}{4}$ " x 28 T.P.I.	3
002	Z/3	45° Angle type, push on, $\frac{1}{4}$ " x 28 T.P.I.	6
003	EA/874	25° Angle type, push on, $\frac{1}{4}$ " x 28 T.P.I.	6
003a	EA/875	Special Lock Nut for Nipples	1

Cheese Head Screws.

Order by SPARES No.	Do not use PART No.	DESCRIPTION OF PART.	No. Per Set.	Parts, Each. L. H. S.
04	A6/373	1 1/4 Dia. $\frac{1}{2}$ " Length under head, $\frac{1}{2}$ " Threads/in 20 ...	20	4
07	1R/756	" $\frac{1}{2}$ " " " " " " " 25 ...	25	4
012	2S/74	" $\frac{1}{2}$ " " " " " " " 20 ...	20	4
013	A6/32	" $\frac{1}{2}$ " " " " " " " 20 ...	20	6
014	A6/33	" $\frac{1}{2}$ " " " " " " " 20 ...	20	4
015	A6/34	" $\frac{1}{2}$ " " " " " " " 20 ...	20	4
016	E10/89	" $\frac{1}{2}$ " " " " " " " 20 ...	20	4

Small Round Head Screws, Etc.

Order by SPARES No.	Do not use PART No.	DESCRIPTION OF PART.	No. Per Set.	Parts, Each. L. H. S.
080	EA/1056	1/8 Dia. $\frac{1}{8}$ " Length under head $\frac{1}{2}$ " Threads/in 32 ...	32	1
085	D11/7	" $\frac{1}{8}$ " " " " " " " 32 ...	32	2
086	C13/70	" $\frac{1}{8}$ " " " " " " " 32 ...	32	1

Studs and Tie Bolts.

Order by SPARES No.	Do not use PART No.	DESCRIPTION OF PART.	No. Per Set.	Parts, Each. L. H. S.
0100	EE/78	1 1/4 Dia. $\frac{1}{2}$ " Length under head $\frac{1}{2}$ " Threads/in 32 ...	32	6
0120	A6/838	" $\frac{1}{2}$ " " " " " " " 20 ...	20	4
0184	A6/581	" $\frac{1}{2}$ " " " " " " " $\frac{1}{2}$ " x 18 & $\frac{1}{2}$ " x 20	4
0184a	A6/536	" $\frac{1}{2}$ " " " " " " " " thick centre	4
0185	1R/171	" $\frac{1}{2}$ " " " " " " " $\frac{1}{2}$ " Threads/in 25 ...	25	1 0
0186	E10/81	" $\frac{1}{2}$ " " " " " " " 2" " 26 & 18	3
0192	A6/83	" $\frac{1}{2}$ " " " " " " " $\frac{1}{2}$ " " " $\frac{1}{2}$ " x 28 & $\frac{1}{2}$ " x 18	3
0276	A6/80	" $\frac{1}{2}$ " " " " " " " 3 $\frac{1}{2}$ " " " 26 ...	26	6
0277	1R/748	" $\frac{1}{2}$ " " " " " " " 3 $\frac{1}{2}$ " " " 26 ...	26	6
0278	1R/410	" $\frac{1}{2}$ " " " " " " " 4 $\frac{1}{2}$ " " " 26 ...	26	6
0282	A1/22	" $\frac{1}{2}$ " " " " " " " 3 $\frac{1}{2}$ " " " 26 ...	26	9
0283	1R/71	" $\frac{1}{2}$ " " " " " " " 3 $\frac{1}{2}$ " " " 26 ...	26	6
0284	1R/47	" $\frac{1}{2}$ " " " " " " " 4 $\frac{1}{2}$ " " " 16 ...	16	6
0286	E10/78	" $\frac{1}{2}$ " " " " " " " 2" " 26 ...	26	4

0100 Tie Bolt for holding Accumulator
6114-29 Nut for top of tie bolt
6130-29 Acetylene Generator Bracket
6131-29 Stay for 6130-29
686 Screw for securing generator stay
6151-31 Battery Platform
6893 Bolt, front of saddle, $\frac{1}{2}$ " x 2 $\frac{1}{2}$ "
62-3 Bolt Locknuts
6216-29 Eye Bolt for saddle spring
61-4 Eye Bolt Nut
6002-29 Saddle
001 Straight type, push on, $\frac{1}{4}$ " x 28 T.P.I.
002 45° Angle type, push on, $\frac{1}{4}$ " x 28 T.P.I.
003 EA/874 25° Angle type, push on, $\frac{1}{4}$ " x 28 T.P.I.
003a EA/875 Special Lock Nut for Nipples
04 A6/373 1 1/4 Dia. $\frac{1}{2}$ " Length under head, $\frac{1}{2}$ " Threads/in 20
07 1R/756 " $\frac{1}{2}$ " " " " " " 25
012 2S/74 " $\frac{1}{2}$ " " " " " " 20
013 A6/32 " $\frac{1}{2}$ " " " " " " 20
014 A6/33 " $\frac{1}{2}$ " " " " " " 20
015 A6/34 " $\frac{1}{2}$ " " " " " " 20
016 E10/89 " $\frac{1}{2}$ " " " " " " 20
080 EA/1056 1/8 Dia. $\frac{1}{8}$ " Length under head $\frac{1}{2}$ " Threads/in 32
085 D11/7 " $\frac{1}{8}$ " " " " " " 32
086 C13/70 " $\frac{1}{8}$ " " " " " " 32
0100 EE/78 1 1/4 Dia. $\frac{1}{2}$ " Length under head $\frac{1}{2}$ " Threads/in 32
0120 A6/838 " $\frac{1}{2}$ " " " " " " 20
0184 A6/581 " $\frac{1}{2}$ " " " " " " $\frac{1}{2}$ " x 18 & $\frac{1}{2}$ " x 20
0184a A6/536 " $\frac{1}{2}$ " " " " " " " thick centre
0185 1R/171 " $\frac{1}{2}$ " " " " " " $\frac{1}{2}$ " Threads/in 25
0186 E10/81 " $\frac{1}{2}$ " " " " " " 2" " 26 & 18
0192 A6/83 " $\frac{1}{2}$ " " " " " " $\frac{1}{2}$ " " " $\frac{1}{2}$ " x 28 & $\frac{1}{2}$ " x 18
0276 A6/80 " $\frac{1}{2}$ " " " " " " 3 $\frac{1}{2}$ " " " 26
0277 1R/748 " $\frac{1}{2}$ " " " " " " 3 $\frac{1}{2}$ " " " 26
0278 1R/410 " $\frac{1}{2}$ " " " " " " 4 $\frac{1}{2}$ " " " 26
0282 A1/22 " $\frac{1}{2}$ " " " " " " 3 $\frac{1}{2}$ " " " 26
0283 1R/71 " $\frac{1}{2}$ " " " " " " 3 $\frac{1}{2}$ " " " 26
0284 1R/47 " $\frac{1}{2}$ " " " " " " 4 $\frac{1}{2}$ " " " 16
0286 E10/78 " $\frac{1}{2}$ " " " " " " 2" " 26
0100 Tie Bolt
6114-29 Nut
6130-29 Bracket
6151-31 Platform
086 Screw
6216-29 Eye Bolt
61-4 Eye Bolt Nut
6002-29 Saddle
002 Grease Nipple
003 Grease Nipple
003A Grease Nipple
001 Grease Nipple
002 Grease Nipple
003A Grease Nipple
04, 07, 012, 013, 014, 015, 016 Small Round Head Screws
080, 085, 086 Small Round Head Screws
0286, 0120, 0184, 0184S, 0185, 0186, 0192, 0276, 0277, 0278, 0282, 0282, 0283, 0284, Small Round Head Screws

GREASE NIPPLES, SCREWS, STUDS, TIE BOLTS, Etc.—Continued.

Order by PART No.	Do not use PART No.	Headed Bolts.	Parts, each L & 2.
0510	E1/100	1/4" 1/2" Length under head 1/2" Threads/in 26	4
0512	E8/1109	1/2" " " " 1/2" " " 26	6
0513	E8/291	1/2" " " " 1/2" " " 26	3
0520	A6/001	1" " " " 1/2" " " 30	20
0521	C13/108	1" " " " 1/2" " " 26	4
0522	C13/84	1" " " " 1/2" " " 25	4
0523	A7/112	1" " " " 1/2" " " 20	4
0562	E8/142	1/2" " " " 1/2" " " 30	6
0563	D9/83	1/2" " " " 1/2" " " 20	6
0564	D9/102	1/2" " " " 1/2" " " 20	4
0566	E4/75	1/2" " " " 1/2" " " 25	4
0567	E8/77K	1/2" " " " 1/2" " " 25	6
0590	E8/548	1/2" " " " 1/2" " " 25	0
0593	E8/617	1/2" " " " 1/2" " " 26	6
0597	E10/73	1/2" " " " 1/2" " " 26	6
0598	A8/83	1/2" " " " 1/2" " " 18	6
0711	E8/455	1/2" " " " 1/2" " " 26	4
0716	E8/547	1/2" " " " 1/2" " " 26	4
0720	E10/70	1/2" " " " 1/2" " " 26	9

NUTS, WASHERS, Etc.

SPARES No.	DESCRIPTION.	Parts, L & 2.
81-1	Nut (standard) 1/2" dia. x 32 T.P.I.	1
81-2	Nut (standard) 1/2" dia. x 36 T.P.I.	1
81-3	Nut (standard) 1/2" dia. x 36 T.P.I.	1
81-4	Nut (standard) 1/2" dia. x 36 T.P.I.	2
82-1	Locknut, 1/2" dia. x 32 T.P.I.	1
82-2	Locknut, 1/2" dia. x 36 T.P.I.	1
82-3	Locknut, 1/2" dia. x 36 T.P.I.	1
82-4	Locknut, 1/2" dia. x 36 T.P.I.	2
82-5	Locknut, 1/2" dia. x 36 T.P.I.	2
85-1	Single Spring Washer, 1/2" dia.	1
85-2	Single Spring Washer, 1/2" dia.	1
85-3	Single Spring Washer, 1/2" dia.	1
85-4	Single Spring Washer, 1/2" dia.	1
85-5	Double Spring Washer, 1/2" dia.	1
85-6	Double Spring Washer, 1/2" dia.	2
89-1	Steel Ball, 1/2" dia.	1
89-1A	Steel Ball, 1/2" dia.	1
89-2	Steel Ball, 1/2" dia.	1
817-3	Split Pin, 1/2" dia. x 1" overall	1
918-1	No. 3 Woodruff Key	3
919-2	Plain Washer, 1/2" dia. hole	1
919-3	Plain Washer, 1/2" dia. hole	1
919-4	Plain Washer, 1/2" dia. hole	1
919-5	Plain Washer, 1/2" dia. hole	1
921-2	Petrol Union Nut	3
921-4	Petrol Union Nipple	3
922-4	Plug, 1/2" dia. x 16 T.P.I.	6
925-2	Slotted Cable Adjuster	1
926-6	Clip for 1/2" dia. tube	4
927-3	Plate for clip S20-6	2

Thread Pts Incl

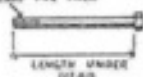

0510, 0512, 0513, 0520, 0521, 0522, 0523
0562, 0563, 0564, 0566, 0567, 0590
0593, 0597, 0598, 0711, 0716
0720



51-1, 51-2, 51-3
51-4.



52-1, 52-2, 52-3
52-4
52-5



59-1, 59-1A
59-2



55-1, 55-2, 55-3
55-4



56-3, -56-6



517-3



518-1



519-2, 519-3
519-4, 519-6



521-2



521-4



522-4



525-2



526-6



527-3

HANDLEBARS AND FITTINGS.

Order by SPARES No. PART No.	Do not use	DESCRIPTION OF PART.	Part, Use? ² No. Per Set. [5, 6.
8400-31	D9/180c	Handlebars, complete with inverted levers and cables only, 350 cc.	1 13 6
8400-29	1/8/180	Handlebar only (plated) 1" O.D. x 1/8", 350 cc. 1	15 0
8404-31	D9/503c	Handlebars, complete with rubber grips, inverted levers and cables only, 250 cc.	1 13 6
8404-29	E8/503	Handlebar only (plated), 1" O.D. x 1/8", 250 cc. 1	10 0
8408-27	X/12	Rubber Grips	1 9
8408-28	X/14	Inverted Lever and Bracket, N.S. or O.S., 350 cc.	4 6
8410-29	Z/14a	Inverted Lever and Bracket, N.S. or O.S., 350 cc.	4 6
8408A-26	Z/13	Inverted Lever only	2 9
8408B-26	Z/116	Inverted Lever Bracket, 350 cc.	1 9
8410B-26	Z/116a	Inverted Lever Bracket, 250 cc.	1 9
8409D-26	Z/117	Inverted Lever Bracket Pin	5
8409E-26	Z/118	Inverted Lever Bracket Pin Nut	2
8416-31	Z/15	Combined Magneto Lever and Exhaust Lever, 250 cc.	8 6
8416A-26	Z/120	Magneto Lever only	1 3
8416B-26	Z/121	Body	2 6
8416D-26	Z/184	Half Clip & Exhaust Lifter Lever Bracket 1	2 9
8416E-26	Z/123	Screw for half clip	2 ...
8416F-26	Z/186	Exhaust Lifter Lever	1 3
8416G-26	Z/189	Pulcrum Pin Exhaust Lever	2
8416H-26	Z/190	Pulcrum Pin Nut	1
8416J-26	Z/196	Spring	2
8416K-26	Z/187	Steel Washer	3 ...
8416L-26	Z/185	Fibre Washer	2
8416M-31		Cap	9
8418N-31		Hex. Pin securing Cap	9
8419-30	Z/214	Exhaust Lifter Trigger Control, complete, 250 cc.	3 9
8418A-30	Z/184	Bottom half Bracket	2 9
8418B-30	Z/183	Trigger	1 3
8418D-30	Z/189	Trigger Pulcrum Pin	2
8418E-30	Z/190	Pulcrum Pin Nut	1
8418F-30	Z/221	Half Clip	9
8418G-30	Z/123	Half Clip Screws	2 ...
8412-31		Magneto Control Lever complete, 350 cc.	4 3
8412A-30		Magneto Control Lever	2 9
8412B-30	Z/121	Magneto Control Body	2 6
8412D-30	Z/122	Magneto Control Half Clip	9
8412E-30	Z/123	Magneto Control Half Clip Screws	2 ...
8412F-30	Z/124	" D " Washer (Steel)	4
8412G-30	Z/125	Nut	4
8412H-30	Z/126	" D " Washer (Steel)	1 ...
8412J-30	Z/127	Spring Washer	3
8412K-30	Z/128	Spring	4
8412L-31		Cap	9
8412M-31		Hexagon Pin Securing Cap	9

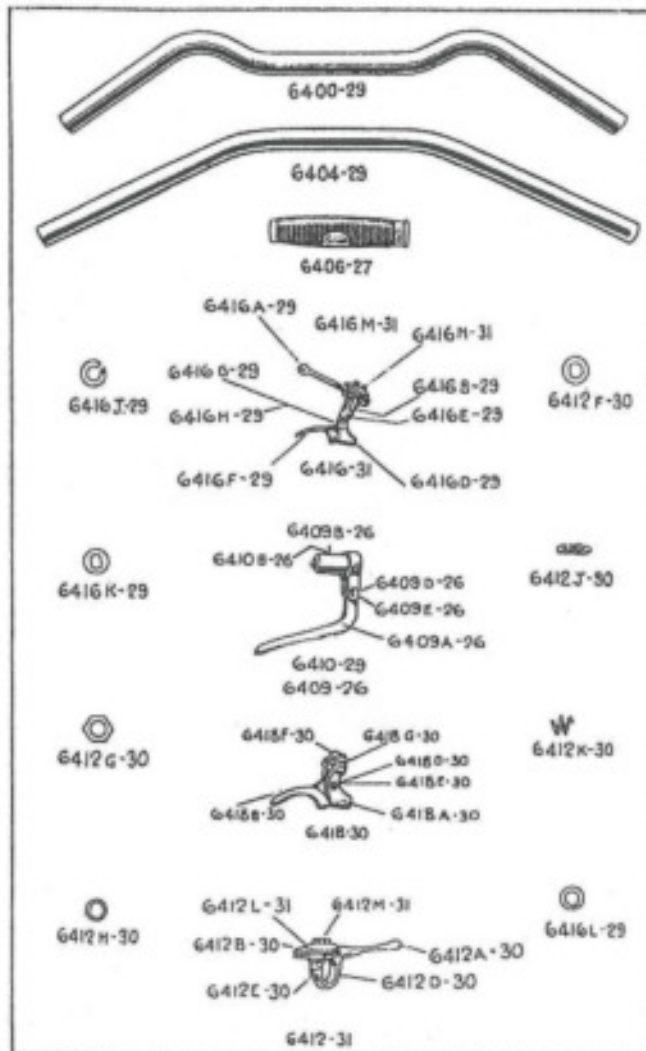

HANDLEBAR AND FITTINGS—Continued.

Order by SPARES No.	Do not use PART No.	DESCRIPTION OF PART.	No. Per Set.	Price, Each. £ s. d.
6414-29	Z/139	Clutch Control Lever, complete, 350 cc.	1	4 6
6414A-29	Z/140	Clutch Control Lever	1	2 6
6414B-29	Z/141	Fulcrum Bar	1	1 6
6414D-29	Z/142	Half Clip, 1" bar	1	8
6414E-29	Z/143	Fulcrum Pin	1	3
6414F-29	Z/144	Fulcrum Pin Nut	1	2
6414G-29	Z/194	Clip Pin	2	4

AMAL CARBURETTOR CONTROL PARTS.

Single Lever Air Control.

When ordering AMAL parts, please prefix the Part No. with the word AMAL, e.g. AMAL 12/003—Control Body.

Order by SPARES No.	Order by AMAL PART No.	DESCRIPTION OF PART.	No. Per Set.	Price, Each. £ s. d.
6417-29		Single Lever Control, complete	1	4 3
	12/003	Control Body	1	1 10
	12/014	Control Lever	1	2 6
	12/018	Handlebar Clip, 1"	2	6
	12/022	Handlebar Clip Screw	1	3
	12/023	Handlebar Clip Screw Nut	1	3
	12/024	Handlebar Clip Rivet	2	2
	12/029	Control Bolt	1	3
	12/031	Control Cap	1	6
	12/033	Spring Washers	2	2

Twist Grip Parts.

When ordering AMAL parts, please prefix the Part No. with the word AMAL, e.g. AMAL 11/011—Cable Stop.

11/001 & 010	(long) Inner Sleeve and Rear Clip	1	3 3
11/004 & 003	(long) Outer Sleeve complete	1	3 3
11/002R	Slide Strip Key and Nipple Carrier	1	1 9
11/009	Rear Clip	1	1 9
11/011	Cable Stop	1	9
11/012	Spring	1	4
11/013	Pin for rear clip	1	3
11/014	Pin for front clip	1	3
11/015	6½" long Rubber Grip	1	1 6
11/023	6½" long Dummy Grip, 1"	1	1 6
11/022	Dummy Grip End Cap, 1" grip	1	4

BOWDEN WIRE CONTROL CABLES.

Magneto Control.

Order by SPARES No.	Do not use PART No.	DESCRIPTION OF PART.	No. Per Set.	Price, Each. £ s. d.
6450-31		Cable and Casing, complete...	1	4 0
6450A-31		Inner Wire	1	6
6450B-31		Outer Casing	1	2 6
0050	Z/139	Ferrule	2	2
0055	Z/134	Nipple (cylindrical), handlebar end	1	2
0056	Z/136	Nipple, magneto end	1	2

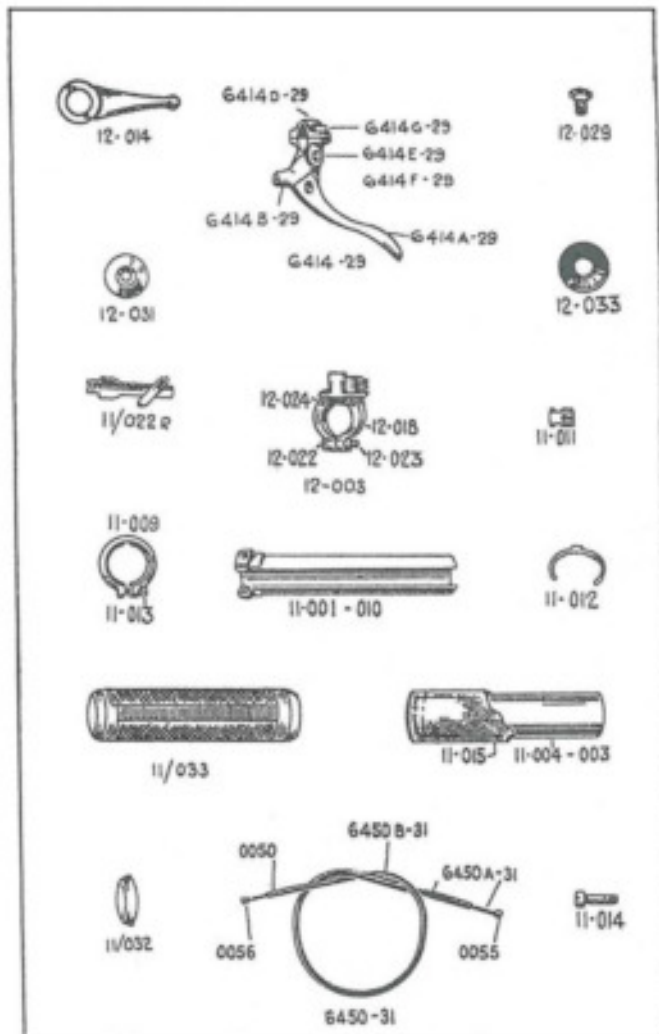

BOWDEN WIRE CONTROL CABLES—Continued.

Order by SPARE No.	Do not use PART No.	DESCRIPTION OF PART.	No. Per Set.	Perk. Excs. £ s. d.
6461-31		Cable complete, 250 cc.	1	4 0
6461A-31		Inner Wire, 250 cc.	1	6
6461B-31		Outer Casing, 4' 3", 250 cc.	1	2 6
6462-31		Cable complete, 350 cc.	1	4 0
6462A-31		Inner Wire, 350 cc.	1	6
6462B-31		Outer Casing, 3' 10", 350 cc.	1	2 6
0057	Z/140	Nipple (cylindrical), handlebar end	1	2
0058	S29	Nipple, gearbox end	1	2
0051		Ferrule	2	2
6461D-31	Z/151	Adjuster Screw	1	6
6461E-31	Z/138	Adjuster Screw Nut	1	1
Exhaust Lifter.				
6471-31		Cable, complete, 250 cc.	1	4 0
6471A-31		Inner Wire, 250 cc.	1	6
6471B-31		Outer Casing, 2' 1", 250 cc.	1	2 6
6472-31		Cable complete, 350 cc.	1	4 0
6472A-31		Inner Casing, 350 cc.	1	6
6472B-31		Outer Casing, 2' 10", 350 cc.	1	2 6
0051		Ferrule	2	2
6471E-31	A8/822	Nut	1	1
6471F-31	A8/263	Volute Spring	1	6
0059	Z/165	Nipple, handlebar end	1	2
0060	D6/22	Nipple, lifter end	1	2
6471G-31	DA/262	Clip, aluminium flat strip	1	2
Front Brake.				
6480-31		Cable, complete	1	2 0
6480A-31		Inner Wire	1	4
6480B-31		Outer Casing	1	2 0
0050	Z/133	Ferrule	2	2
0059	Z/1A5	Nipple (cylindrical) handlebar end	1	2
0060	D/0/22	Nipple (spherical), brake end	1	2
Throttle Control.				
6491-31		Cable, complete	1	4 0
6491A-31		Throttle Inner Wire, 38" long	1	6
6491B-31		Throttle Outer Casing, 32½" long	1	2 6
*AMAL 12/025		Ferrules	2	2
*AMAL 11/017		Nipple, handlebar end	1	2
*AMAL 4/036		Nipple, carburettor end	1	2
Air Control.				
6501-31		Cable, complete	1	4 0
6501A-31		Air Cable Inner Wire, 34" long	1	6
6501B-31		Air Cable Outer Casing, 28½" long	1	2 6
*AMAL 12/025		Ferrule	2	2
*AMAL 12/034		Nipple, handlebar end	1	2
*AMAL 4/036		Nipple, carburettor end	1	2

Order by AMAL Part No.

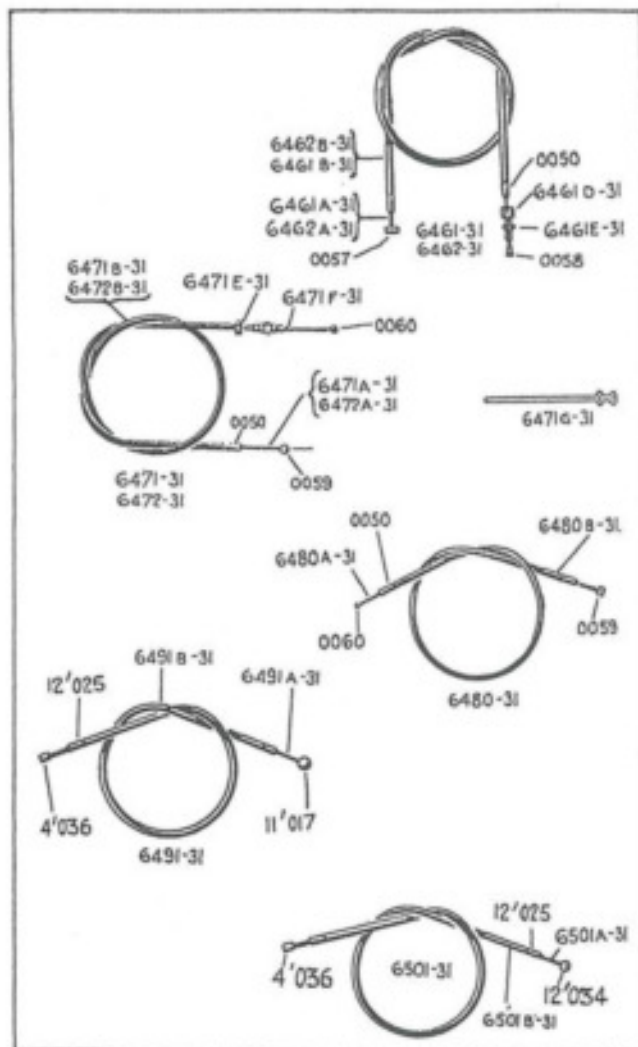

AMAL CARBURETTOR TYPES 4 & 5.

*When ordering AMAL parts, please specify the Part No. with the word AMAL, e.g.
AMAL 14/012—Mixing Chamber.*

Mixing Chamber Parts.

Order by AMAL Part No.	DESCRIPTION OF PART.	PRICE, BANG.	
		No. Per Set.	£ s. d.
4/012	Mixing Chamber, 250 cc.	1	8 0
5/011	Mixing Chamber, 350 cc.	1	10 0
4/008	Jet Block and Barrel, complete, size 21, 250 cc.	1	5 0
5/008	Jet Block and Barrel, complete, size 31, 350 cc.	1	5 0
4/031	Mixing Chamber Cap	1	1 9
4/032	Mixing Chamber Top	1	1 9
4/002	Mixing Chamber Union Nut	1	1 0
4/035	Cable Adjusters	2	4
4/037	Throttle Valve Spring	1	3
4/038	Air Funnel	1	2 0
4/040	Washer for jet block	1	2
4/041	Spring Clip for needle	1	4
4/042	Main Jet. State size required	1	8
4/043	Holding Bolt	1	2 0
4/045	Air Valve, 250 cc.	1	2 0
5/045	Air Valve, 350 cc.	1	2 0
4/048	Air Valve Spring	1	3
4/047	Air or Throttle Valve Guide	1	3
4/048	Outlet Clip Screw	1	6
4/049	Outlet Clip, 1"	1	1 0
4/052	Throttle Valve, 250 cc.	1	3 10
5/052	Throttle Valve, No. 6, 350 cc.	1	3 10
4/053	Holding Bolt Washer	2	2
4/061	Needle Jet	1	1 9
4/065	Needle for Jet, 250 cc.	1	1 3
5/065	Needle for Jet, 350 cc.	1	1 3
13/129	Air Adjusting Screw	1	6
4/072	Spring for Adjusting Screw	1	2
4/083	Throttle Stop Screw	1	6
18/010	Locknut for screw	1	2

Float Chamber. 250 cc. Models.

22/000	Float Chamber complete, Top Feed, S.V. model	1	17 0
22/079	Float Chamber complete, Bottom Feed, O.H.V. Model	1	17 0
22/000LB	Float Chamber, body only, Top Feed	1	8 6
22/001	Float Chamber body only, Bottom Feed	1	8 6
22/012	Float Chamber Cover, Top Feed	1	4 3
22/011	Float Chamber Cover, Bottom Feed	1	4 3
22/016	Float	1	2 0
22/013	Float Needle, Bottom Feed	1	11
22/014	Float Needle, Top Feed	1	11
14/025	Petrol Union Nut	1	6
14/026	Petrol Union Nipple	1	2
22/021	Tickler	1	7
14/032	Tickler Spring	1	3
14/033	Cotter for Tickler	1	1



AMAL CARBURETTOR—TYPES 4 & 5—Continued.

Float Chamber. 350 cc. Models.

Order by AMAL PART No.	DESCRIPTION OF PART.	No. per Set.	Price, Each £ s. d.
14/001	Float Chamber Body (Standard Base)	1	12 0
14/011	Float Chamber Cover, complete	1	2 6
14/012	Cover Lock Screw	1	6
14/015	Float	1	2 6
14/024	Needle	1	11
14/025	Petrol Union Nut	1	0
14/026	Petrol Union Nipple	1	3
14/031	Tickler	1	7
14/032	Tickler Spring	1	2
14/033	Coater for tickler	1	1

TOOL KIT.

Order by SPARES No.	Do not use PART No.	DESCRIPTION OF PART.	No. per Set.	Price, each. £ s. d.
6651-30	14/1072	Tool Box with fixing strip	2	3 6
6600-29	G1/28	Double-Ended Spanner (fits $\frac{1}{8}$ " & $\frac{1}{4}$ " bolts)	1	8
6603-28	G1/59	Double-Ended Spanner (fits $\frac{1}{8}$ " & $\frac{1}{4}$ " bolts)	1	1 6
6604-28	G1/60	Double-Ended Spanner (fits $\frac{1}{8}$ " & $\frac{1}{4}$ " bolts)	1	9
6605-28	G1/61	Double-Ended Spanner (fits $\frac{1}{8}$ " & $\frac{1}{4}$ " bolts)	1	9
6606-27	G1/55	Double-Ended Spanner (head nut and wheel cone nut)	1	1 9
6606-30	G1/50a	Double-Ended Spanner	1	1 9
6603-29	G1/78	Single-Ended Spanner (wheel cone nut) 1 S.V., 2 O.H.V.	1	1 0
6610-29	G1/73	Valve Cap Spanner (S.V. only)	1	1 9
6611-27	G1/58	Tube Spanner (engine sprocket locking sleeve)	1	1 0
6611-29	G1/72	Tube Spanner (gearbox securing bolt)	1	1 0
6611-31	G1/59	Tube Spanner	1	1 0
6612-27	G1/57	Tommy Bar	1	8
6613-29	G1/79	Plug for tube spanner	1	6
6616-29	G1/33	Screwdriver	1	9
6616-28	G1/80	Screwdriver for clutch	1	6
6617-28	Z/20	Magneto Spanner	1	6
6620-29	G1/84	Pinion Extractor and Set Pin	1	2 6
6623-29	G1/85	Set Pin only for pinion extractor	1	6
6624-29	G1/80	Extractor for sleeve on engine shock absorber	1	2 6
6625-28	Z/31	Tyre Lever	1	6
6627-30	G1/56	Link Plate for Model L.F. Heblers	1	8
6628-28	G1/87c	Valve Spring Compressor, S.V.	1	3 6
6632-29	G1/75	Valve Spring Compressor, O.H.V.	1	3 6
6635-27	Z/21	Grease Gun	1	6 0
6639-29	Z/22	Tyre Inflator, 14 $\frac{1}{2}$ " x $\frac{1}{4}$ "	1	4 0
6640-28	Z/23	Tool Roll (Canvas)	2	1 0
6683-31		Set of Tools only, in tool roll, S.V.	1	0 0
6684-31		Set of Tools only, in tool roll, O.H.V.	1	0 0

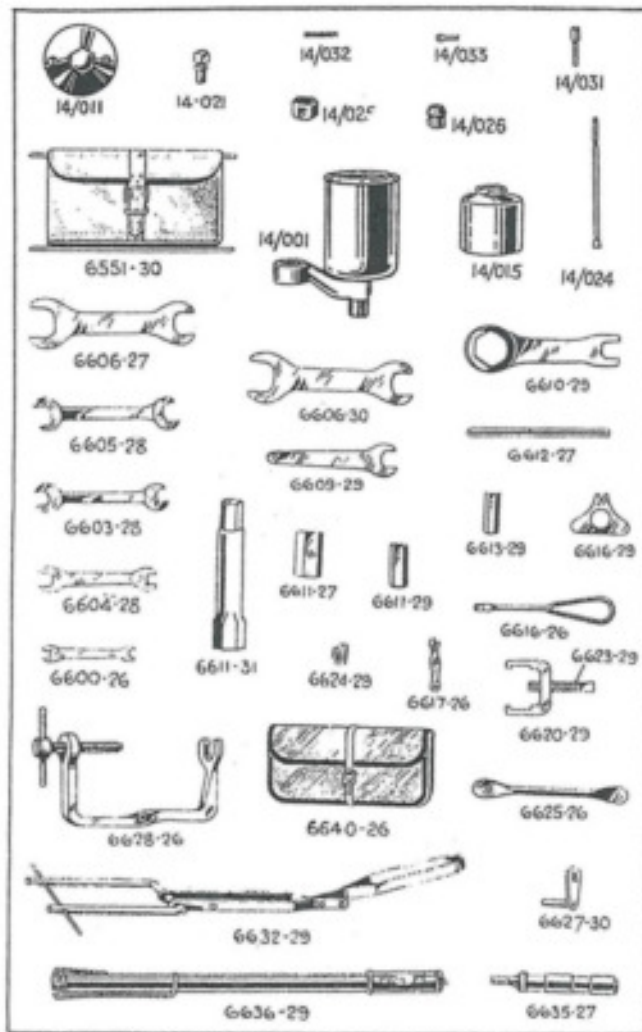

BURMAN GEARBOX. MODEL R.P.

PART No.	MARK No.	DESCRIPTION OF PART.	Price £ s. d.
1RP		Gearbox	1 3 0
2R	1	Kick Starter Case (speedometer drive)	15 0
3R	1	Clutch Lever Bracket (speedometer drive)	7 8
4/R	11	Clutch Lever Bracket Studs (short)	2
62X	1	Clutch Lever Bracket Studs (long)	4
60X		Gear Box Studs	8
63X		Gearbox Stud Nuts	2
7R	11	Clutch Operating Lever (for 3-R m/l.)	2 0
8R	11	Clutch Operating Lever Pin (for 3-R m/l.)	9
67X		Clutch Lever Ball	1
11R	111	Mainshaft	1 0 0
32R		Mainshaft Bearing	10 0
12R	1	Mainshaft Nut (K.S. end)	3
70X		Mainshaft Nut (clutch end)	3
13R		Mainshaft Washer	1
14R		Mainshaft Sliding Gear	1 6
15R	1	Driving Gear	1 5 0
16R	1	Driving Gear Bash	3 0
82X		Driving Gear Nut	1 6
18R		Driving Gear Bearing	12 8
19R		Driving Gear Washer	3
20R		Bearing Dust Cover	4
78X		Bearing Retaining Ring	4
22R	1	Driving Sprocket (1 7/8" x .305")	10 0
23R	1	Sprocket Spacing Collar	5 8
24R	1	Third Driving Gear	10 0
25R	1	Layshaft Small Gear	15 0
26R		Layshaft Sliding Gear	17 6
27R	1	Layshaft Large Gear	15 0
114X	111	Kick Starter Lever	5 0
115X		Kick Starter Lever Pedal	3 0
125X	111	Kick Starter Centre Pin	4 8
126X		Kick Starter Centre Pin (for extended K.S.)	5 0
128X		Centre Pin Washer	2
127X		Centre Pin Cotter	1
124X		Kick Starter Lever Bash	1 6
116X		Kick Starter Quadrant	10 0
130X		Kick Starter Spring	2 0
132X		Kick Starter Case Spring Pin	3
133X		Kick Starter Stop Peg	8
134X		Stop Peg Rubber	4
135X		Stop Peg Bolt	4
65X		Stop Peg Nut	3
136X		Stop Peg Washer	3
138X		Kick Starter Case Cover	2 0
87R		Cable Bracket	1 0
103R		Adjuster Bolt Pivot Pin	6
28R	1	Layshaft Spindle (speedometer drive)	15 0
29R	11	Layshaft Spindle Bush (gearbox)	3 0
29R	1	Layshaft Spindle Bush (K.S. covr)	3 0

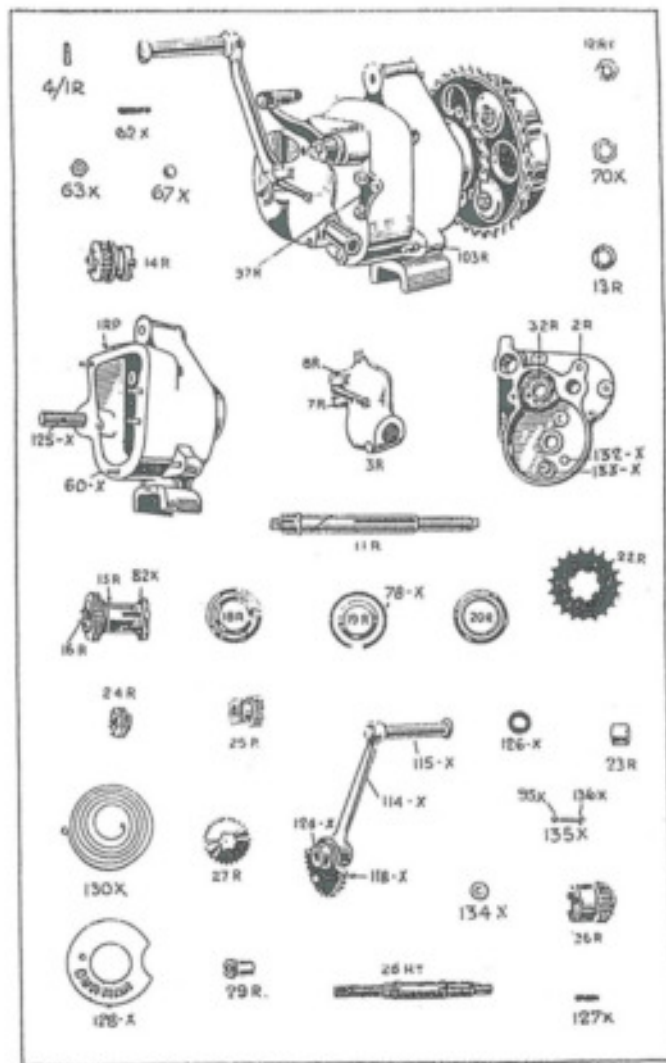

HURMAN GEARBOX, MODEL R.P. Continued.

PART No.	MARK No.	DESCRIPTION OF PART.	QTY.	Per Set	
21R		Layshaft Cover Washer	2		
33R		Ratchet Pinion	6	0	
34R		Ratchet Pinion Bush	2	0	
35R		Ratchet Pinion Spring	9		
36R		Driving Ratchet	4	0	
37R		Bell Crank Inner Lever	5	0	
38R		Bell Crank Spindle	2	3	
82X		Bell Crank Spindle Washer	1		
10X		Bell Crank Spindle Nut	1		
89X		Operating Block	2	0	
42R		Pawl	1	9	
94X		Pawl Bearing Screw	1	3	
95X		Pawl Screw Nut	3		
45R		Pawl Spring	9		
98X		Pawl Spring Plug	1	0	
99X		Trunion Ball	1	6	
48R		Control Inner Lever	4	0	
49R		Control Inner Lever Bolt	1	0	
102X		Control Lever Bolt Nut	3		
51R		Control Lever Bolt Washer	2		
52R		Control Lever Bush	3	0	
105X		Outer Lever (long)	5	0	
64R		Outer Lever Extension Sleeve	4	0	
55R		Outer Lever Spring Washer	2		
77R	II	Clutch Case (3 Plate)	10	0	
78R	II	Clutch Centre (3 Plate)	10	0	
79R	I	Cork Plate, fitted cork	4	0	
79R	II	Clutch Plate, fitted fabric	4	6	
79R	III	Cork Plate, re-corking only, per plate	1	0	
79R	IV	Special Asbestos Fabric, inserts, per plate	1	0	
80R		Plain Plate	2	0	
81R	II	Chain Wheel (4" x .300")	17	0	
82R		Holler Race	2	0	
83R		Holler Race Washer	6		
35X		Hollers	17 per set	2	0
92R		Clutch Springs	3		
94R		Spring Adjusting Nut	4		
95R	II	Spring Studs (3 Plate)	4		
9X		Chain Wheel Bolt	3		
10X		Chain Wheel Bolt Nut	3		
99R		Spring Plate	7	0	
99X	IV	Spring Plate Adjusting Nut	3		
11X	VI	Spring Plate Adjusting Screw	3		
93R		Spring Cup	6		
11X	II	Buffer Rubber	2		
8X	IV	Buffer Cover Plate	9		
96R		Clutch Operating Rods	1	0	
88R	I	Speedometer Spindle	5	0	
110X	I	Speedometer Sleeve	3	6	
112X		Speedometer Thrust Ball	8		

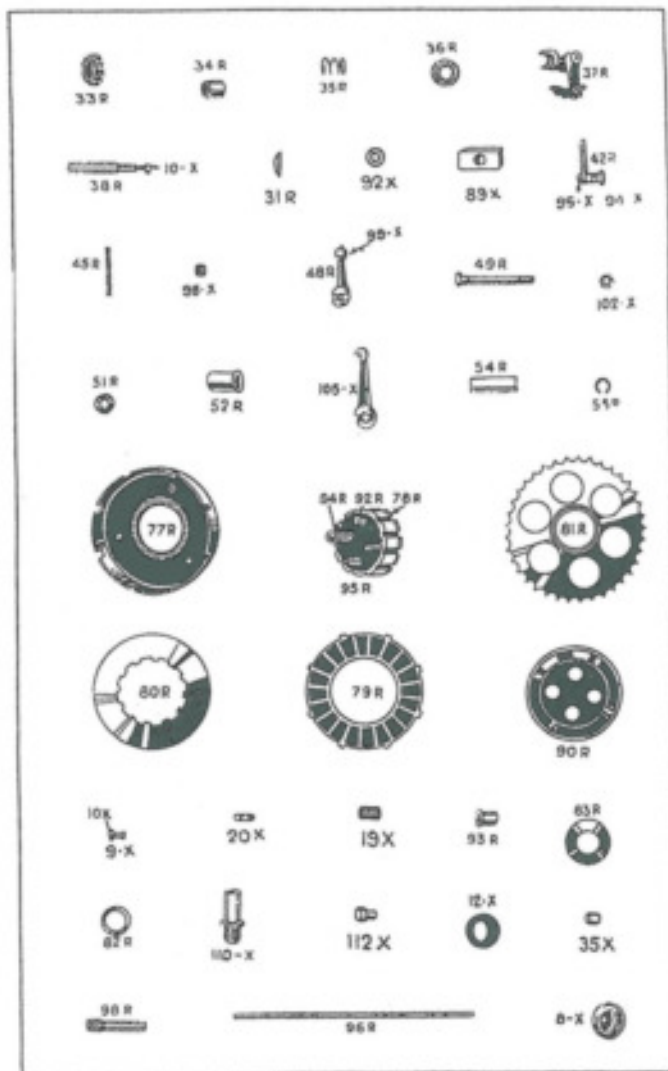

HURMAN GEARBOX, MODEL R.P. Continued.

PART No.	MARK No.	DESCRIPTION OF PART.	Quan. 4.
101R		Shaft Bearing Washer	3
102R		Clutch Bracket Distance Piece	1 0
111X		Speedometer Drive Plug	1 0
105R		Grease Retaining Washer	1 0
110R		Fibre Grease Washer	3

LUCAS MAGDYNO TYPE MSI.

Order by LUCAS PART No.	DESCRIPTION OF PART.	Q. 4.
AY601	Armature complete with lugs. (less outer ring)	30 0 each.
E51	Field Coils	5 0 "
D11	Set of Brushes	3 0 set.
ZY1	Cut-out complete	6 0 each.
QY1001	C.E. Cover Fixing Nut, complete with washer	9 "
A8	C.E. Ball Race complete with outer ring	5 3 "
A13	D.E. Ball Race complete with outer ring	5 3 "
BY1022	C.E. Bracket complete with Brush Gear-anti	21 6 "

Magneto Section.

AY625	Magneto: Arm, complete with lugs. (less outer rings)	42 0 each.
A15	Ball Bearing complete with outer ring	5 0 "
641B/640	Earth Carbon and Holder	8 "
641B/642	Earth Brush and Spring	6 "
OY780	Pick-up complete	2 0 "
S15/M823/1	Pick-up Carbon, Brush and Spring	6 "

Armature Components—Dynamo Section.

M450/1A	Woodruff Key	1 0 dozen.
---------	---------------------	------------

Armature Components—Magneto Section.

M450/1A	Woodruff Key	1 0 dozen.
M255/2J	M81/0 Slip Ring	3 0 each.

Body Components—Dynamo Section.

M2191/2B	M8/2 Dynamo Fixing Strap	6 each.
M2191/3	M8/2 Dynamo Fixing Strap Bush	3 0 dozen.

Brush Gear Components.

M274/4A	Spring Lever—right hand	2 0 dozen.
M274/5A	Spring Lever—left hand	2 0 "
L2272/2	Spring Lever Control	2 0 "
M813/1B	Terminal Shield	3 0 "
M288/1	Brush Spring—right hand	3 0 "
M288/2	Brush Spring—left hand	3 0 "

Contact Breaker End Components.

M1633/4	Terminal	3 0 dozen.
M1799/2	C. B. End Plate Packing Felt	1 0 "
M481/4	Timing Cage Cover	4 each.

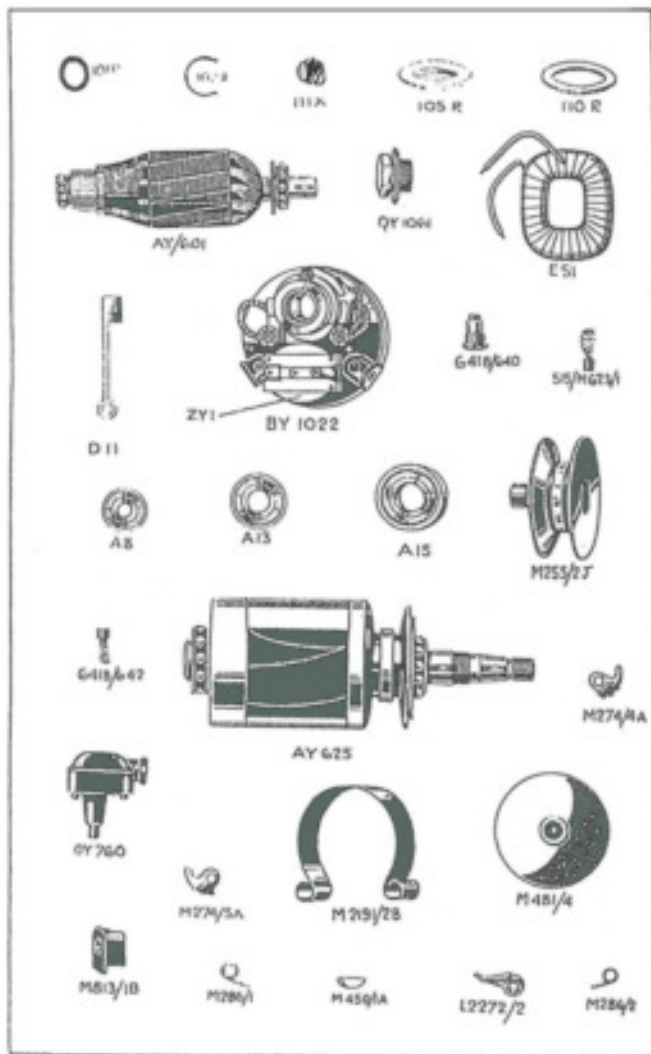

LUCAS MAGDYNO TYPE M.S.1—Continued.

Contact Breaker Components.

Order by LUCAS PART No.	DESCRIPTION OF PART.	Q.	U.
TM7730	Contact Breaker c/w contact—anti.	13	0 each.
TM1805/2/A	Lever complete with Tungsten Contact—anti.	2	0 ..
TM820/6B	Contact Screw with Contact	1	3 ..
572/794A	Actuating Spring—long	2	0 dozen.
168/815	Auxiliary Spring—short	1	0 ..
1082/1262	Contact Breaker Fixing Screw	3	0 ..
128/788A	Long Screw for springs	9	..
408/AM11	Short Screw for springs	9	..

Cut-Out Components.

L2283/1E	Connector	9	0 dozen.
M1931/60	Coil Spring	2	0 ..

Driving End Components.

M1893/3A	Gear Wheel (magneto section) Driver	1	0 each.
M1766/40	Gear Wheel (Dynamo section) Driven	2	0 ..
M1741/4	Dynamo Securing Nipple	2	0 dozen.

Nuts.

T8No. 873	D.K. Bracket Fixing Screw (long) Nut	9	0 dozen.
L782/8	Terminal Nut	1	0 ..
M1488/2	Cut-out Fixing Nut	1	0 ..
M653/1	Driving Gear Lock Nut	2	0 ..
888/1036	Magneto Armature Spindle Nut	2	0 ..
M481/8	Spring Control Lock Nut	9	..

Pins.

M1254/3B	Spring Pin—Control	2	0 dozen.
----------	---------------------------	---	----------

Screws.

L983/5A	Terminal Screw	9	0 dozen.
L837/4	Terminal Fixing Screw	9	..
T8789	Cut-out Insulating Plate Fixing Screw	9	0 ..
L581/6	C.K. Bracket Fixing Screw	1	0 ..
AM2	Pick-up Cable Screw	1	0 ..
M353/2B	Dynamo Gear Locking Screw	3	0 ..
324/235	C.B. End Plate Fixing Screw (countersunk)	1	0 ..
L486/4B	C.B. End Plate Fixing Screw (cheese head)	9	..
M1072/1B	C.B. End Plate Seal Screw	1	0 ..
M2012/2	Dynamo Locating Screw	1	3 ..
M1232/4A	Spring Control Fixing Screw	1	0 ..
M785/6A	Spring Control Screw	1	0 ..

Spring Control Components.

M1576/3	Plunger—anti-clock	9	0 each.
M1447/4	Spring	3	0 dozen.
M424/3G	Nipple	1	0 ..
M588/5	Cap	9	0 each.
M481/5	Cable Stop	3	0 dozen.
M786/1	Rubber Cap	3	0 ..

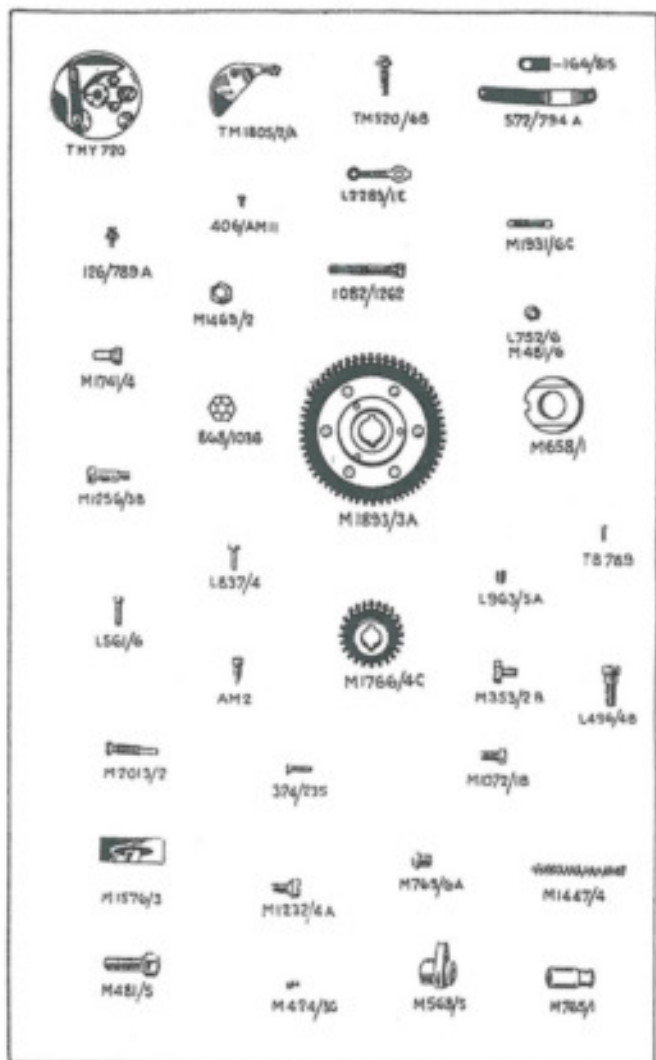

LUCAS MAGDYNO TYPE M.S.J.—Continued.

Washers.

Order by LUCAS PART No.	DESCRIPTION OF PART.	Pack. 4, 6, 10 dozen.
M684/4	Pick-up Jointing Washer	1 0 dozen.
M1671/4	Driving End Plate Paper Washer	6 "
M1881/4	Slip Ring Linen Washer	9 "
M586/4	Magneto Gear Washer	1 0 "
1102/1209	Magneto Armature Spindle Nut Washer	9 "
M353/1	Dynamo Gear Locking Washer	1 0 "
M2191/4	M8/2 Dynamo Strap Fixing Screw Lock Washer	6 "

LUCAS H 52 HEAD LAMP.

(Used with Magdyno Sets).

Order by LUCAS PART No.	DESCRIPTION OF PART.	4, 6, 10 each.
F085/EB	Body complete—Black Finish	11 0 each.
SW3388	Contact Insulating Plate complete	3 0 "
SA188	Bulb Holder Interior, D.P. Main Bulb	1 0 "
SA188	Bulb Holder Interior, S.P. Pilot Bulb	6 "
MW367	Reflector complete	10 0 "
H52/6V	Switch complete (loss cables) 6 volt	10 0 "
AMP12	Ammeter complete, illuminated type, bottom slot	8 0 "
M0175	Switch Body complete with Terminals and 1/2 inch stud insert	7 0 "
B099	Contact Levers (K, H, and L.H.) c/w springs and rollers	6 "
SW2559	Shaft Head Piece complete with insert	9 "
M0216/CH/Ass	Front Rim with metal and glass.	11 0 "

Ammeter Components.

L2636/3	Fixing Spring	6 each.
L2671/4	Bayonet Ring	6 "

Front Components.

6647/266	Glass—No. 609 Gauge	2 0 each.
6647/267	Rubber Cord for Glass	1 0 dozen.

Washers.

SW3382	For Switch Fixing Pin	3 dozen.
SW2511	For Switch Knob Fixing Screw	3 "
SW3718	Side Fixing Bolt Washer	6 "
SW967	Bracket Fixing Bolt Spring Washer	9 "
SW2280	Short Lamp Fixing Bolt Washer	1 3 "

Switch Components.

80230	Resistance Wire with plates, 6 volt	1 0 each.
SW3389	Rubber Ring	6 dozen.
SW2577	Contact Plunger	1 0 "
SW2578	Contact Plunger Spring	1 0 "
SW2576	Contact Plunger Roller	1 0 "
SW282	Switch Handle	1 0 each.

Nuts.

SW3283	For switch fixing pin	1 3 dozen.
SW3376	For fixing switch	2 0 "
SW1223 49	Bracket Arm Fixing Bolt Nut	1 0 "

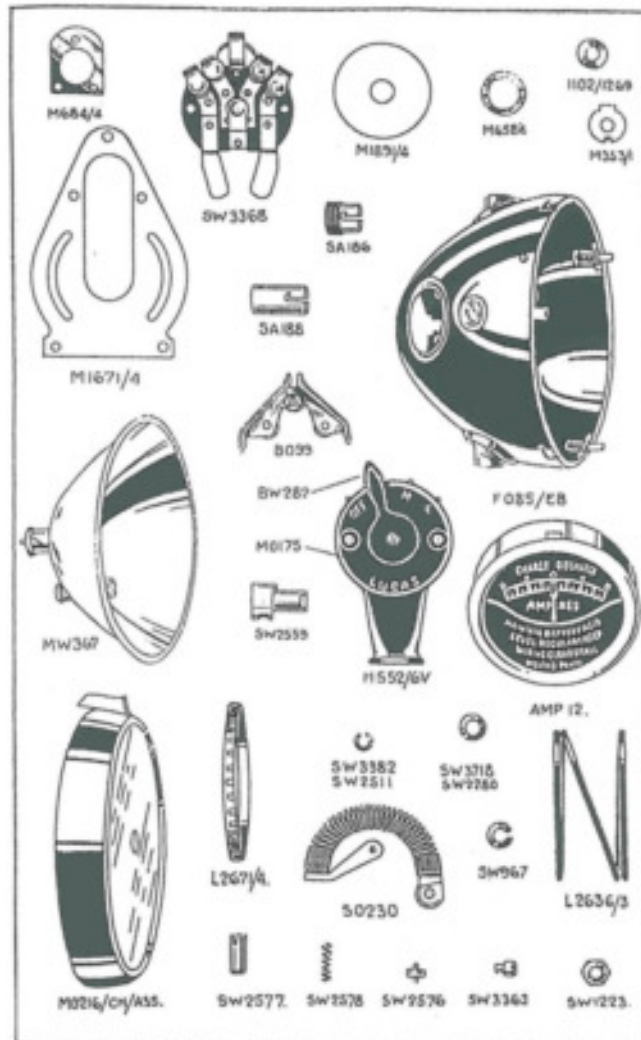

LUCAS H 52 HEAD LAMP—Continued.

Screws.

Order by LUCAS PART No.	DESCRIPTION OF PART.	Q. T.
SW2595	For Fixing Lamp	3 0 dozen.
SW3528	For Fixing Switch Handle	2 0 "
SW2522	For Terminals	6 "
SW3391	For Terminals (Contact Screw)	6 "
SW3393	For Cable Clip	3 each.
SW2505	Bracket Arm No. 1 Fixing Bolt	2 0 dozen.
SW1537	Short Lamp Fixing Bolt	4 each.

No. 9 Handlebar Dipper Switch.

Order by LUCAS PART No.	DESCRIPTION OF PART.	Q. T.
SW3339	Switch Cover	9 each.
SW3856	Terminals Screw	6 dozen.
SW3892	Fixing Clip (1" handlebar)	3 0 "
SW3207	Fixing Clip Screw	1 6 "
SW3206	Fixing Clip Screw Nut	1 6 "
SW3205	Fixing Clip Screw Barrel	1 6 "

MT110 TAIL LAMP.

Order by LUCAS PART No.	DESCRIPTION OF PART.	Q. T.
B0103	Back Half complete (less bulb)	4 3 each.
B0102	Front Half	3 0 "
SW530	Cable Bush	3 0 dozen.
BA585	Bulb	1 3 each.

PUWSE BATTERY.

Order by LUCAS PART No.	DESCRIPTION OF PART.	Q. T.
82204/1	Moulded Cover	2 3 each.
8007	Moulded Cover Rubber Buffers	1 0 dozen.
82203/5	Moulded Cell Lid	5 each.
	Positive Section Assembly	1 4 "
	Negative Section Assembly	1 10 "
8001	Cable Connector	4 6 dozen.
82177/6	Separators	16 8 per 100
82203/6	Connector	2 0 dozen.
8005	Terminal Post Locking Ring	1 0 "
82203/4	Cell Bottom Hests	3 0 "
8008	Vest Plug with washer	4 each.
8009	Vest Plug Rubber Washer	8 dozen.
8196	Terminal Post Lead Washer	6 "
PUWSE/804	Battery Carrier complete	2 6 each.
8W552	Top Strap	6 "
8W4523	Top Strap Barrel	4 "
8W583	Fixing Rod	3 0 dozen.
8W3880	Fixing Rod Nut	3 0 "
8W3894	Barrel Nut	2 0 "

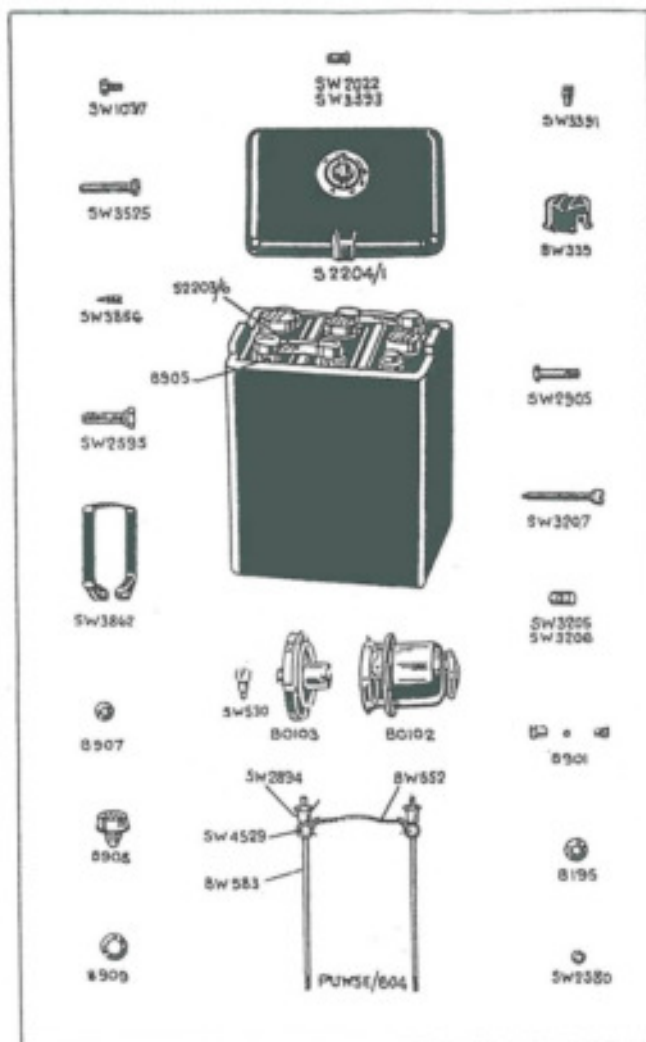

LUCAS MAGLITA.
TYPE FD, 20 WATT, E TYPE, K SPINDLE.

M.L. Magneto, Type F.D. Anti-Clock.

Refer by LUCAS PART No.	DESCRIPTION OF PART.	Price s. d.
12AK	Armature complete with Bearing and Cam ...	42 0 each.
4481	Armature Spindle Nut ...	2 0 dozen.
4482	Armature Spindle Nut Washer ...	1 0 "
10A10	Armature Nut ...	6 each.
10A15	Armature Nut Jump Ring ...	2 0 dozen.
15LD	Cut-out complete ...	8 9 each.
18E1T	Top Cover ...	4 0 "
8C155	Top Cover Fixing Screw ...	2 0 dozen.
9LG7	Top Cover Gland Nut ...	3 0 "
9L08	Top Cover Screwed Gland ...	3 0 "
10F1	Contact Breaker Cover only ...	3 0 each.
10T10	Contact Breaker Cover Securing Spring ...	6 "
15HLT	Ignition Coil complete (top terminal type) ...	26 0 "
8C204	Ignition Coil Fixing Screw ...	3 0 dozen.
15A4	Ignition Coil Fixing Screw Brass Washer ...	2 0 "
478A	Ignition Coil Fixing Screw Washer (spring) ...	1 0 "
15G	D.K. Bearing Housing complete with Bearing ...	8 6 each.
5C183	D.K. Bearing Housing Fixing Screw ...	2 0 dozen.
478A	D.K. Bearing Housing Fixing Screw Washer ...	1 0 "
9T8	Magnet ...	18 0 each.
9Q	H.T. Terminal ...	2 0 "
7Q2	H.T. Terminal Washer ...	2 0 dozen.
168	H.T. Terminal Fixing Screw ...	2 0 "
9N	Contact Breaker Moulding ...	2 0 each.
8CR180	Contact Breaker Moulding Fixing Screw ...	3 0 dozen.
13N4	Contact Spring ...	3 0 dozen.
13N6	Rocker Arm ...	3 0 each.
4152	Contact Screw with Contact ...	3 0 "
4122/26	Spring with Contact ...	3 0 "
8CR174	Spring with Contact Fixing Screw ...	3 0 dozen.
7N6	Jump Ring ...	2 0 "
4354	Rocker Arm Eccentric Timing Screw ...	6 each.
4133	Rocker Arm Eccentric Timing Screw Washer ...	1 0 dozen.
82V	Contact Screw Lock Nut ...	1 0 dozen.
12B1R	Brush Moulding—right hand ...	2 0 each.
12B1L	Brush Moulding—left hand ...	2 0 "
7B6	Brush Spring ...	3 0 dozen.
10B7	Carbon Brush complete with Lead and Eyelet ...	1 9 each.
7B9	Terminal Nut—slotted ...	1 0 dozen.
8C289	Brush Moulding Fixing Screw ...	3 0 "
12K2	Condenser Connector Cleat ...	3 0 "
8C238	Brush Holder Fixing Screw ...	3 0 "
12B15	Brush Holder Fixing Screw Insulated Washer ...	2 0 "
484	Brush Holder Fixing Screw Plain ...	1 0 "

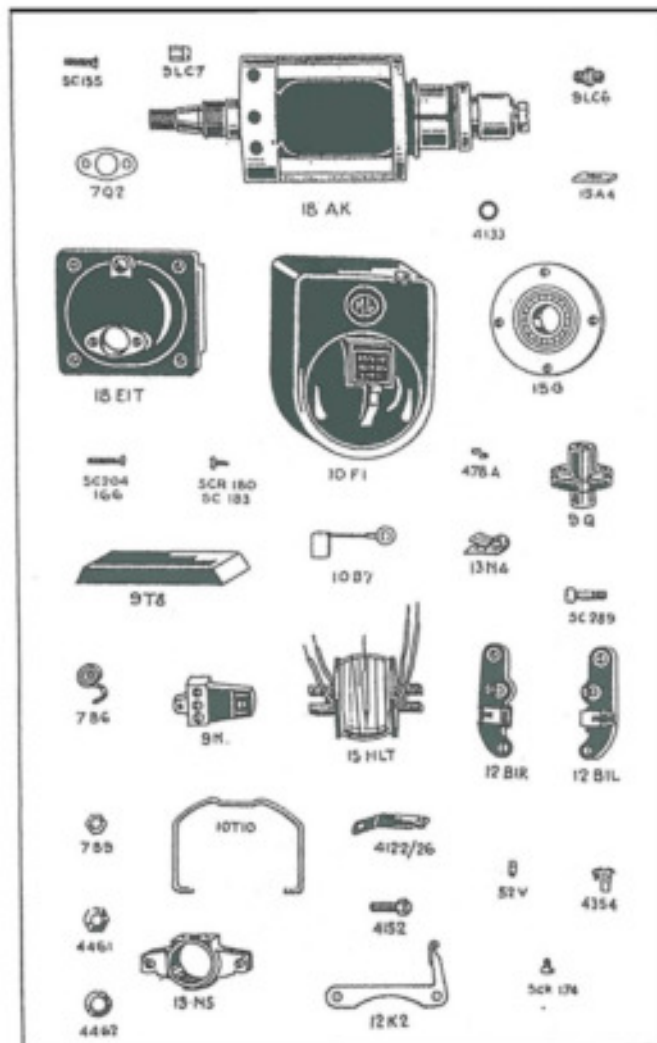

LUCAS MAGLITA—Continued.

Order by LUCAS PART No.	DESCRIPTION OF PART.	Q.	U.
12K1	Condenser	8	8 each.
12K6	Condenser Fixing Clip	4	..
SCR111	Condenser Fixing Screw	3	0 dozen.
405	Condenser Fixing Screw Spring Washer	1	0 ..
80R242	Condenser to clear fixing screw	2	0 ..

M40 HEAD LAMP.
(Used with Maglita Sets.)

Order by LUCAS PART No.	DESCRIPTION OF PART.	Q.	U.
F W302Ass	Body complete with cable clip	10	8 each.
M0241	Front Rim (Ch. Plate) complete with glass and motif	8	8 ..
MWS45	Glass only	1	0 ..
BW607Ass	Bulb Holder Bracket complete with insul. piece, phosphor bronze contact, and bulb holder shell	2	0 ..
8A157	Bulb Holder Interior complete—D.P.	1	0 ..
8W877	Side Fixing Clip Shell	2	8 dozen.
8W403	Bulb Holder Clip Locking Lever	2	6 ..
8W4391	Reflector Back Shell Spring	2	6 ..
8W459	Reflector Back Shell	10	each.
8W4583	Front Glass Jointing Bead	3	0 dozen.
612/DVM0	Main Bulb	4	0 each.
8A585	Pilot Bulb	1	3 ..
8W739	Side Socket Screw Nut... ..	2	0 dozen.
8W3809	Front Rim Fixing Screw complete with ring	2	0 ..
8W3182	Side Socket Screw	4	each.
8W718	Side Socket Screw Washer	2	0 dozen.
8W4555	Side Socket Distance Collar	4	each.
8W178Ass	Switch Body complete with terminals and fixing stud	2	0 ..
8W2588Ass	Shaft complete with Head Piece	9	..
8W2580	Switch Knob	9	..
8W2588Ass	Contact Lever—L.H.—complete with roller	3	0 dozen.
8W3375	Switch Fixing Nut	2	0 ..
8W2035	Switch Knob Fixing Screw	2	0 ..
8W3022	Switch Terminal Screw	8	..
8W809	Switch Fixing Nut Spring Washer	8	..

For Dimmer Switch, see under H20 Head Lamp.

